

User Manual

iRiver SlimX™

MULTI - CODEC CD PLAYER / FM TUNER

Firmware Upgradable

Model iMP-350

MP3
DIGITAL AUDIO
FM
TUNER

Plays
Windows
Media

COMPACT
disc
DIGITAL AUDIO



Thank you for purchasing the product.
Please read manual carefully before use.

iRiver Limited

www.iRiver.com

Introducing iRiver website

SlimX™

- URL : <http://www.iRiver.com>
- Provides information on our company, products, and contacting point for our customers.
- Unique feature of "Firmware (System software) Upgrade" keeps providing premium disc readability and various optional add-on features, supporting new CODEC to be introduced in the future.
- Provides FAQ as well as Beginner's Guide
- Set up customer registration to enable online customer service so that all iRiver users receive the latest information, firmware upgrade, etc. via newsletters.

iRiver Limited does not assume any responsibility for errors or omissions in this document or make any commitment to update the information contained herein.

iRiver is a registered trademark of iRiver Limited in the Republic of Korea and /or other countries and is used under license. Microsoft Windows Media and the windows Logo are trademarks or registered trademarks of Microsoft Corporation in the United States and /or other countries. WinAmp and WinAmp logo is registered trademark of NullSoft Inc.

All other brand and product names are trademarks of their respective companies or organization. All other product names may be trademarks of the companies with which they are associated.

©1999-2002 iRiver Limited. All right reserved.

Unique Features of iRiver SlimX

- **Multi-Codec CD Player**
: Supports MP3, WMA and ASF format as well as conventional Audio CD.

- **Firmware Upgrade**
: Provides the latest updated features via firmware upgrade.
New formats such as AAC, MP3 Pro and Ogg Vorbis can be supported in the future with a simple upgrade method. Player features such as add on, modification, and continuous improvement of disc recognition are always provided.

- **Recognize Discs in Packet Write Format**
: Provides convenience and efficient usage of CD-RW disc as a hard disc drive.

- **Graphic LCD supporting Multiple Languages**
: Support 35 major languages i.e English, French, Spanish, German, Italian, other alphabet-oriented fonts, Korean, Japanese (Katagana, Hiragana, Kanji),and Chinese (Traditional, Simplified : Hardware type with 16MB flash memory)

- **Built-in Rechargeable Function with Over Charge Protection Circuit**
- **Enhanced Anti-Shock Protection**
: 180 Sec for conventional Audio CD/480Sec for MP3 (44.1KHz, 128kbps standard)/960 Sec for WMA with pre-buffering technology applied to minimize the skipping at initial track reading.

- **FM Tuner**
: Auto scanning and frequency memory function make it easy for you to enjoy listening to the FM Radio.

- **Simple and Convenient Directory Navigation as well as Full Playback /Program Playback Mode**

- **Various Control Options Available in the Graphic User Interface**
- **WinAmp Playlist Playback Support**

1	1. Locating the Controls	
	Player Front & Back	4
	Player Side	5
	Remote Control, LCD Window	6
2	2. Getting started	
	Playing Disc Media	7~8
	Playing FM Tuner	9~10
	Operating Remote Control	11~12
3	3. Useful Features	
	Navigation Mode	13
	Playback Mode	14
	Program Mode	15~16
	+10,-10/Equalizer Mode	17
	Function Control Mode	19~26
4	4. Additional Information	
	Additional Functions	27~29
	Power Supply	30~32
	Trouble Shooting	33~34
	Precautions	35~36
	Reference	37
	Accessories	38
	Product Specifications	39

Locating Controls (Player) SlimX™

Front



Rear

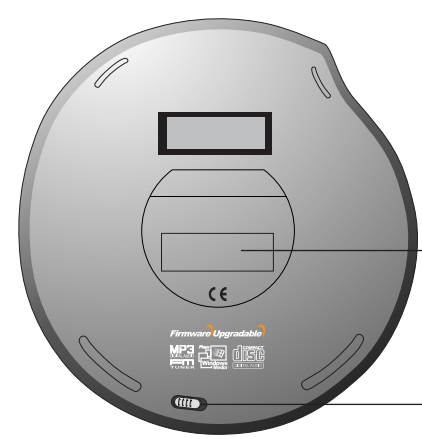

Product
Serial Number

HOLD

Locating Controls (Player) SlimX™

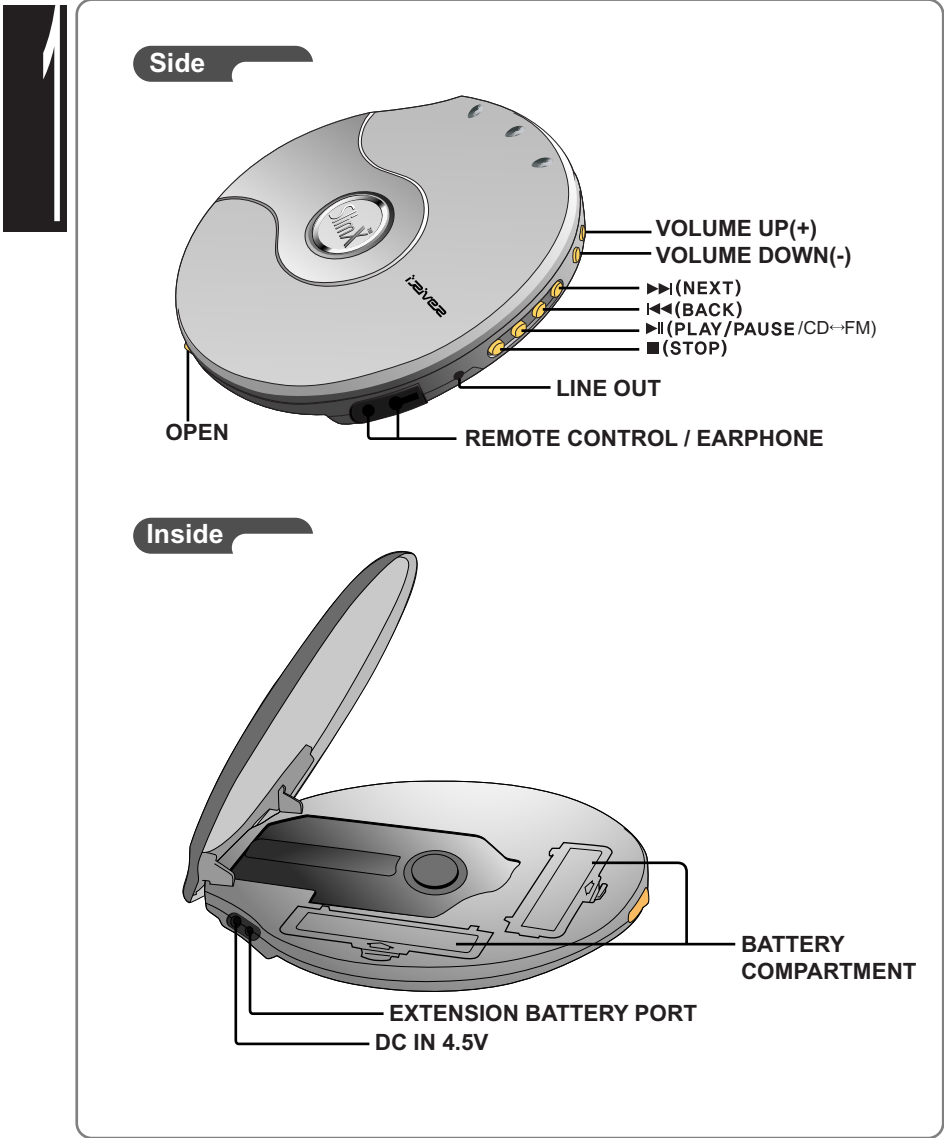

Locating the Controls (Remote Control) SlimX™

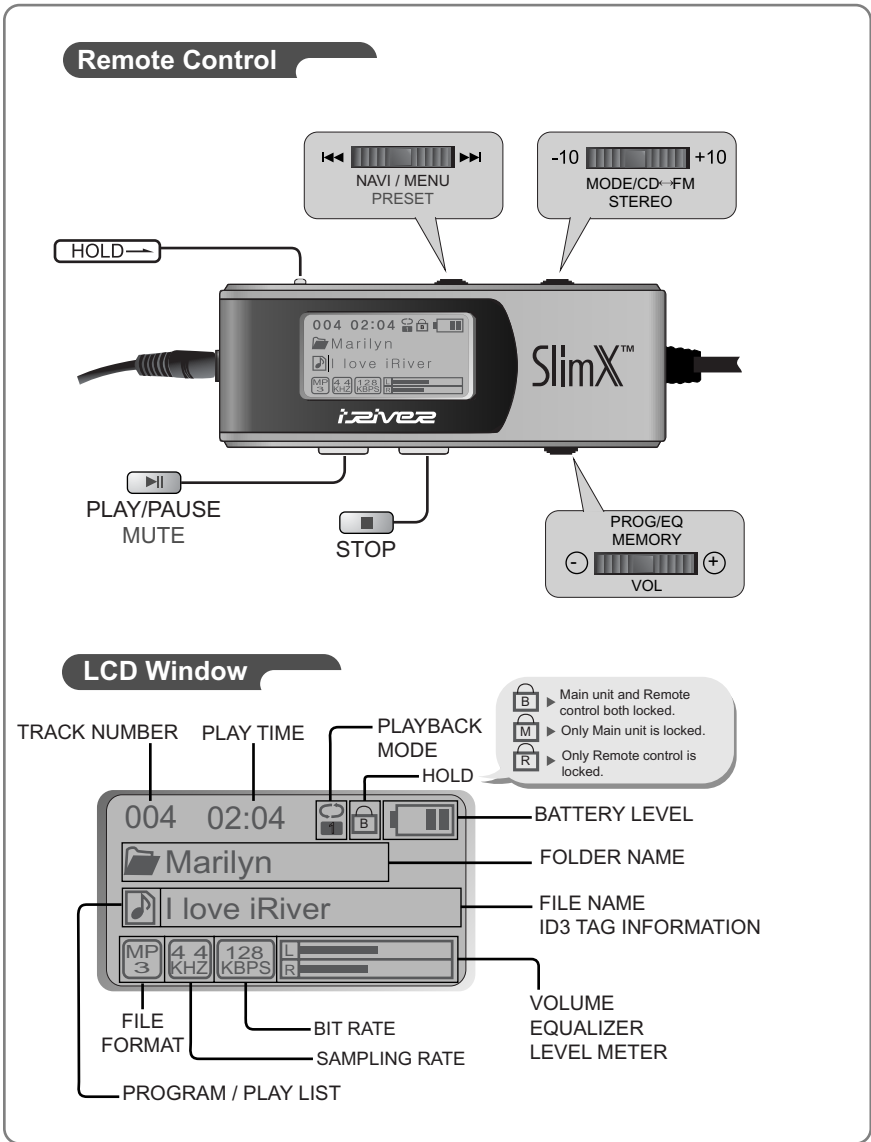

2

● Slide open button, open the player lid and insert the disc.

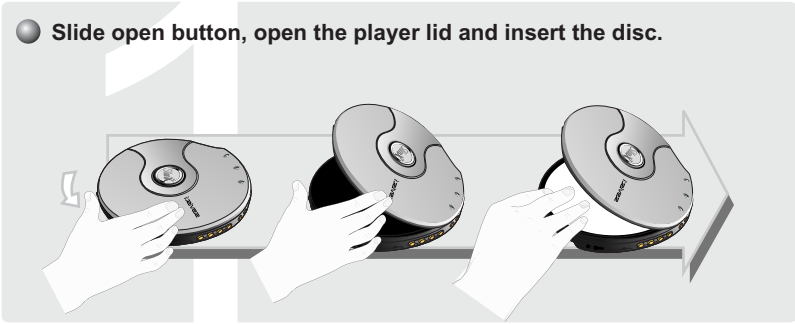

● Connect Remote Control and Earphone.

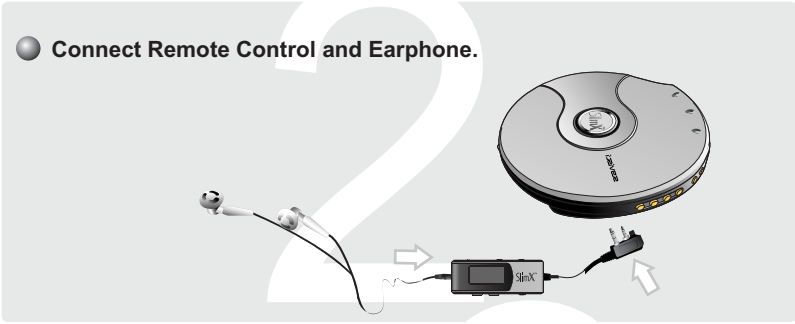

● Slide HOLD Switch to Off position.

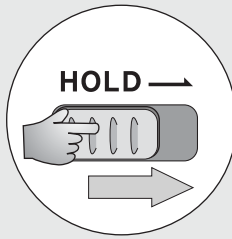

Note: Please be advised that the controls on the player don't work when HOLD switch is ON.

Play/Pause (Click)
CD ↔ FM Changing (Long Click)
STOP (Click)

Play Next Track (Click) **Play Previous Track** (Click)
Play Next Folder (Click + Long Click)
Play Previous Folder (Click + Long Click)
GO Forward Quickly (Long Click)
Go Backward Quickly (Long Click)
Power Off (Long Click)

Tip

File Format displayed as below

AS F < ASF	WM A < WMA
C D < Conventional Audio CD	MP 3 < MP3



Playing FM Tuner SlimX™

2

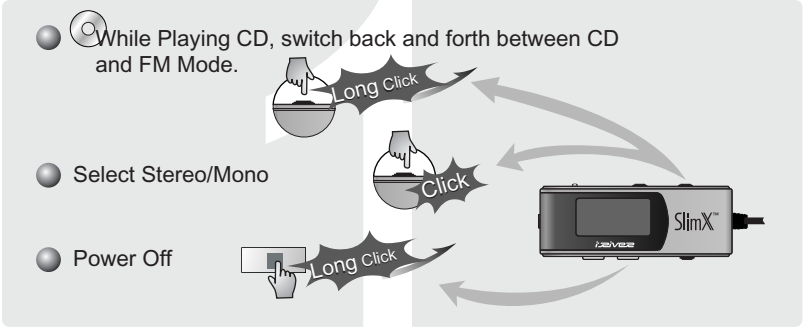

● Selecting Frequency(FM 87.5MHz ~ 108MHz)

1) To change frequency, push the Navi/Menu jog lever **◀◀** or **▶▶** shortly.
(ex : 87.5 → 87.6)

2) Auto Scan function: To select Channels automatically, release preset and push jog lever **◀◀** and **▶▶** .
(ex : 89.1 → 91.9)

3) PRESET Mode : To select memorized channel, push the Navi/Menu jog lever and find the channel by shifting **◀◀** or **▶▶** .

- ▶ FM Tuner receivability may differ in different areas.
- ▶ While in Preset mode, auto scan and auto memory function are not available.
- ▶ When player doesn't have any preset channels, EMPTY will be displayed at preset mode then fade out.

● Memory Function (Save channels)

1 Select the channel by pushing the jog lever or .◀◀ ▶▶

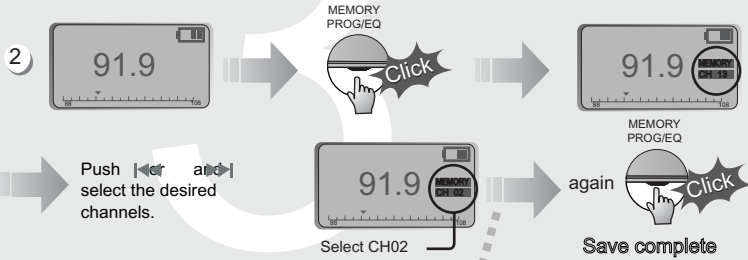

3 Up to 20 channels can be memorized.

4 Auto memory function :
Automatically select channels and save them in sequential orders. (It only activates while the player is not in PRESET mode)

► Note : Auto memory may not work within weak transmission areas.

● Memory delete function (Delete saved channels)

1 Select channel to be deleted at preset mode.

2 Push memory button for a long time.

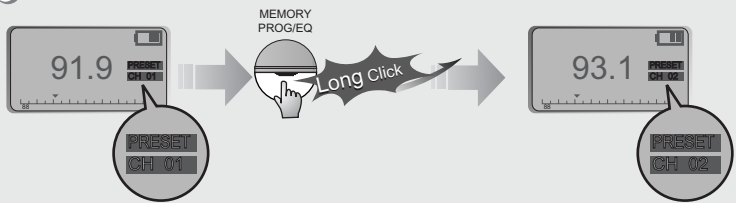

- The next channel will appear when channel delete is completed. Push memory button if you want to delete the next channel also.



Operating Remote Control SlimX™

The remote control operates every function using 3 jog levers and two buttons.

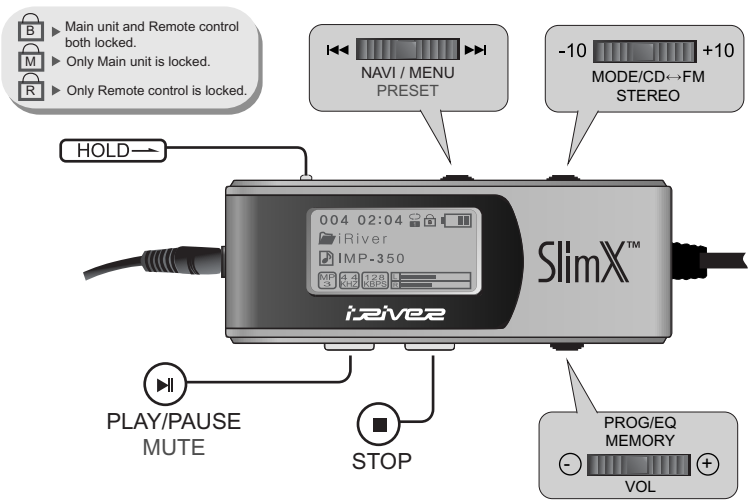
2



Basic operation function

-  Playback and Pause
-  Stop and Power Off

 To listen to the previous track, please push the jog lever to the left. To listen to the next track, please push the jog lever to the right.

Menu Operation



Navigation Operation



Basic Operation



Volume Control: Slide jog lever to the right or to the left.



Changing Mode :



(Refer. p25)

CD ↔ FM Changing :



NAVIGATION

Push NAVI/MENU jog lever shortly and find the desired track by sliding ◀◀ or ▶▶ .

To select the track, please push Navi/Menu(or ▶|) shortly.

To move to the upper directory, press ◼ or short click NAVI/MENU

MENU

Long press of NAVI/MENU will execute menu function.

- ① Shifting between menus : Push ◀◀ and ▶▶
- ② Exit : Press ◼ or long Push NAVI/MENU jog lever.
- ③ Select Function: Click Navi/Menu jog lever(or ▶|).

MODE



While CD is playing, do a short click of MODE/CD ↔ FM to activate selected modes.



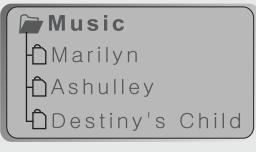

● **NAVIGATION** is the function to search track.

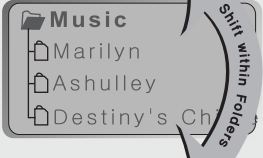



You can find the desired song by using  and  buttons.

1 NAVI/MENU jog lever.  → 

2  →  Shift to upper folder (left arrow) / Shift to down folder (right arrow)

3 **Select Folder or Shift to Upper Folder**
 →  or  : Select Folder
 : Shift to Upper Folder

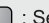
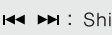
4 **Select the track**
 →  or  : Select the track
 : Shift up/down within the folder





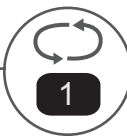
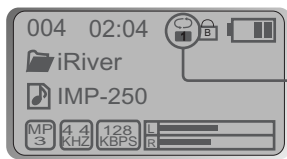

You can enjoy various ways of playing by using playback mode. Please refer to the function controls (page 25) for user-defined configuration.







◀ When MODE/CD↔ FM jog lever is pushed, icon in the playback mode indicator is changed.

● REPEAT

	Play a single track repeatedly.
	Play whole tracks in the directory and stop.
	Play whole tracks in the directory repeatedly.
	Play whole tracks in the disk repeatedly.

● SHUFFLE

SFL	Randomly play whole tracks in the disk repeatedly and stop.
	Play a single track repeatedly.
	Randomly play whole tracks in the directory repeatedly and stop.
	Randomly play whole tracks in the directory repeatedly.
	Randomly play whole tracks in the disk repeatedly.

● INTRO

	INTRO: Play beginning 10 seconds of each track in sequential order. INTRO HIGHLIGHT: Play 10 seconds from the spot 1 minute played for each track in sequential order. Above feature can be selected within Function Control.
---	---



- **Program mode: Play tracks in your favorite order.**
- **Select Program/Playlist:**
 - ▷ Playback play lists if the disc contains WinAmp play list *.m3u files. (Refer page. 29~30)

1 Activating Program mode

At stop mode

Shift to Program mode ▶

- ▷ Program mode is activated while in Stop Mode.
- ▷ Repeat A-B is activated while in Play Mode.

- Use ◀◀ or ▶▶ of Navi/Menu or -10 or +10 of Mode/CD ↔ FM to select the desired track and press

ex) ▼

PROGRAM 001-001

ROOT

I LOVE YOU

PROGRAM 002-002

ROOT

Love is over

Say good-bye

PROG/EQ

PROGRAM 001-001

ROOT

I LOVE YOU

001-001

Track number in program list

Track number within the disc

- ▷ Use Navi/Menu button to select the folder and press PROG button to save the whole track within the folder (Sub folders are not saved)
- ▷ To erase Programmed track: Move to the track and press MODE button, program list will be updated automatically.

Program play

After programming, press  to play the tracks in sequential order.

Program mode icon  appears

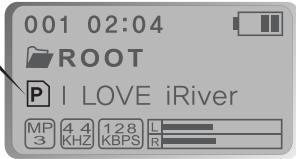

Cancel Program Mode

While Playing 

While in Stop Mode 

Interval Repeat

Play selected interval repeatedly



Press button once to select the beginning <A> Point.



Press button again to select the ending Point.

▲ A-B interval will be repeated.

Tip

When you program songs, using the +/- button will show you the songs that aren't programmed.



+10/-10 MODE

- During playing, push the jog lever to +10/-10, will skip to the next 10th track or backward to previous 10th track.

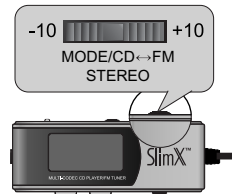

- Enhanced Anti-Shock Mode:
Toggle On/Off by sliding "MODE" button +10 side during PLAY mode.
Caution: Badly recorded CD disk may have inferior disk readability while enhanced anti-shock mode is activated.
In this case, please disable the Enhanced Anti-Shock mode.

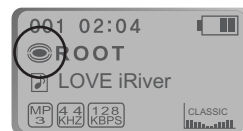

EQ MODE

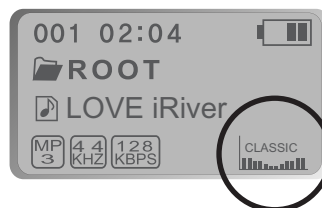

Long click of PROG/EQ jog lever displays the current EQ. Everytime you click this jog lever, the EQ mode shifts in sequential order.



Note: Please refer to the Function Control (Page 28) for configuring User Defined EQ.

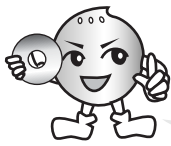

iriver SlimX™ is a Multi-Codec (MP3, WMA, ASF, etc.) Digital Player as well as a CD player with FM tuner.

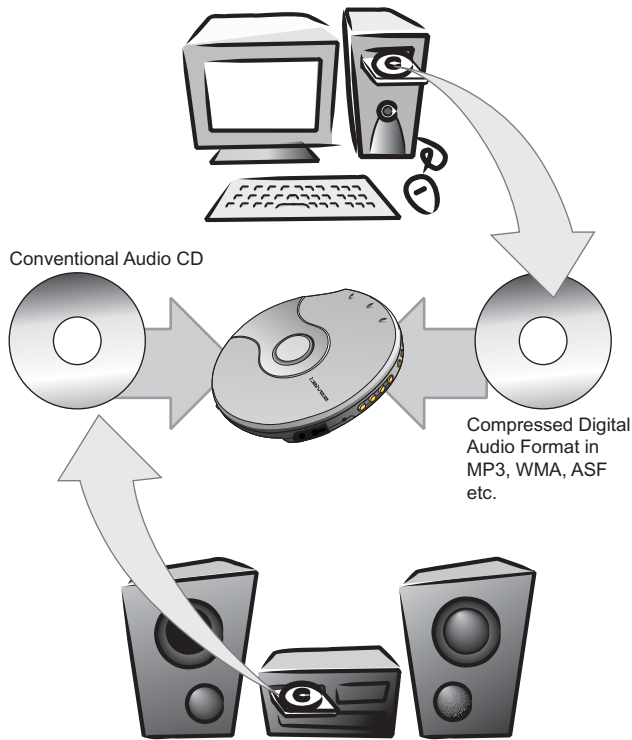

Function Control is subject to change with different firmware versions. Users can configure their own settings.

Configuration

GENERAL

- beep volume
- resume
- fade in
- language
- cd esp
- load default

DISPLAY

- back light
- main lcd contrast
- remote lcd contrast
- tag information
- visualization
- time

TIMER

- sleep
- pwr off

CONTROL

- fast scan
- fast skip
- scan speed
- scroll speed
- remote mode button
- auto pause
- adapter volume
- sound balance

MODE

- repeat
- shuffle
- intro
- study
- name

User EQ

- bass boost
- bass corner freq
- treble boost
- treble corner freq

※ Function Control Option can only be configured in CD Mode.

Menu Operation

- Pressing NAVI/MENU jog lever will show you the figures. It is composed of 6 main menus with submenus.

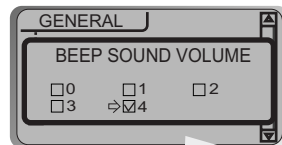

When you select the sub menu window, you can set the user's preference to be displayed.

▼ Main menu

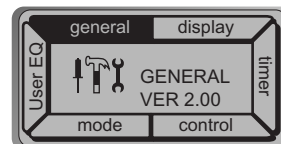

▼ Sub menu

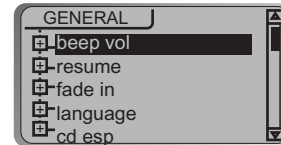

● **Shift between Menu**

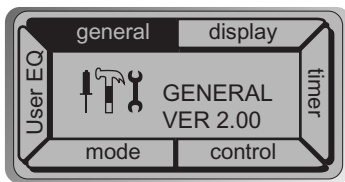

◀ Press **⏪** or **⏩** to move between main menu and sub menu.

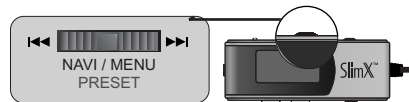

● **From Main Menu to Sub Menu**

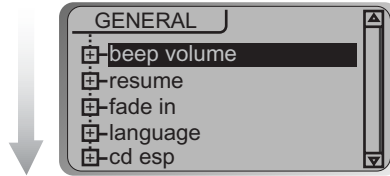
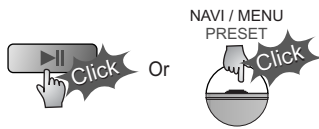

● **Enter Sub Menu**

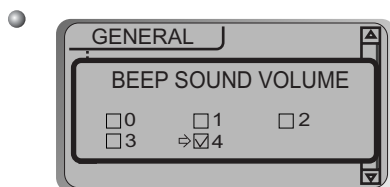
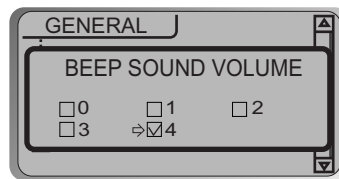
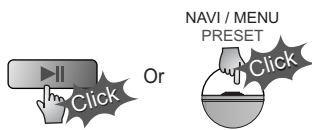

◀ Each control option is configured by three buttons shown below.

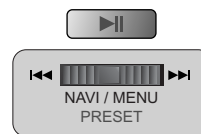

● **Exit Sub Menu**



● **Exit Function Control mode**





● GENERAL

● BEEP VOL
: Configure beep sound (ON/OFF) with volume level.

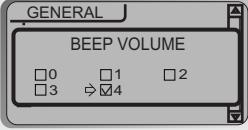

● RESUME
: When activated, player returns to the same settings after STOP or Power OFF.

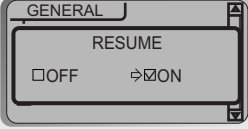

● SOUND FADE IN
: When activated, volume increases gradually at playback Mode to prevent sudden loudness.

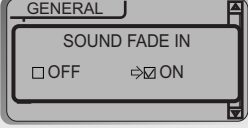

● LANGUAGE(Supports 35 languages)
: When activated, displays proper fonts for tracks and ID3 tag information (which differs from PC operation system in different language).



● CD ANTI-SHOCK
: Pre-buffering technology applied to minimize the skipping from external shock.
Playing Audio CD: Select 180 seconds to maximize skip protection, select 45 seconds to maximize sound quality.
Playing Compressed Digital Audio: Always activate in 480 seconds.

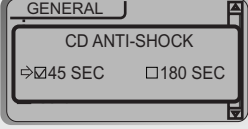

● LOAD DEFAULT VALUE
: Initialize to original factory setting.
button operation order is as below.
▶|| (select default menu) → ◀◀(select YES)
→ ▶|| (select YES : Initialization)

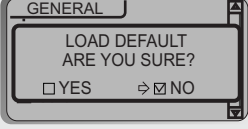

DISPLAY

B.LIGHT

OFF : Backlight is always off.
 Button On works as below :
 1: About 3~10 seconds 2: 10 seconds
 3: 20 seconds
 Adaptor on : Backlight is always turns on when the Adaptor is connected. When the adaptor is not connected, the backlight works as below
 1: About 3~10 seconds 2: 10 seconds 3: 20 seconds 4: Always

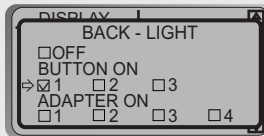

During playing long click of takes the backlight duration for 10 seconds.

LCD CONTRAST

: Adjust LCD contrast of remote control.

Contrast can be adjusted by using and buttons.



VISUALIZATION

: Visualize audio signal at play mode.

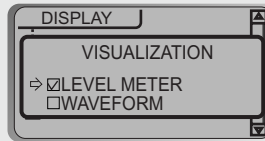

TAG INFO

On: Display track with ID3 tag information.
 OFF: Display track with file name.

When you set off the tag information, the track is playing and the next track can be displayed with ID3 tag information.



TIME

Normal: Display elapsed time.
 Remain: Display remaining time.

Note: If the track format is VBR (Variable Bit Rate), the remaining time may not be accurate.

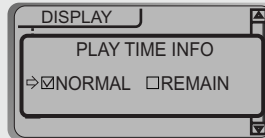

TIMER(Set Auto Power Off)

SLEEP POWER OFF

: Automatically power off after fixed time
(Time range can be set from 0 to 99 minutes by minute)

Use **⏪** or **⏩** button to adjust time.

▷ Available with both CD and FM Tuner

▷ When the power is off, the sleep power off setting goes back to Zero setting.

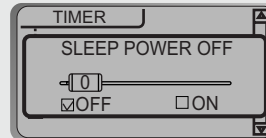

STOP POWER OFF

: Automatically power off at stop mode.
(1~60 minutes)

Use **⏪** or **⏩** button to adjust time.

▷ This function only works for CD.

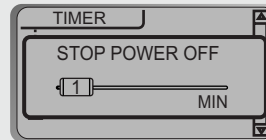

CONTROL

FF/RW SCAN

ON : Long click of **⏪** or **⏩** button for fast scan within the track.

Short click of **⏪** or **⏩** button for skipping.

OFF : Fast scan within the folder.

As of typical characteristics of MP3 CD, fast scan may not be as smooth as conventional Audio CD, typically with VBR (Variable Bit Rate) tracks.

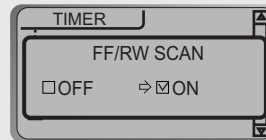



FF/RW SKIP

OFF : Skip does not activate.

10 : Playback previous or next 10th track.

Directory : Skip to previous or next directory.

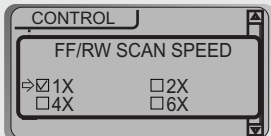

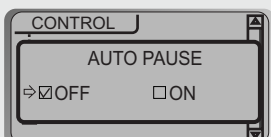
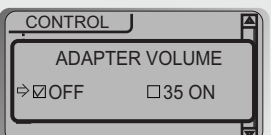
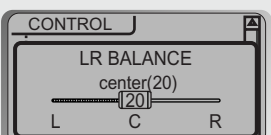
<p>● FF/RW SCAN SKIP The fast scan speed can range from 1x/2x/4x/6x. It is useful when studying a language.</p>	
<p>● SCROLL SPEED Adjust scan speed by 1x/2x/4x/6x Vertical : The scroll goes from up to down Horizontal : The scroll goes from the left to the right.</p>	
<p>● PAUSE(AUTO PAUSE) : When activated, playback is automatically paused between the tracks, playing the next song available only by pressing the Play button each time.</p>	
<p>● ADAPTOR VOLUME ON : When the Adaptor is connected, the volume always remains at level 35. OFF : No use of Adaptor volume.</p>	
<p>● SOUND BALANCE When the lever on the Sound Balance bar is moved to L(Left, 0), the sound output will be in the left earphone. When the lever on the Sound Balance bar is moved to R(Right, 40) the sound output will be in the right earphone. The default value is 20 and the sound output will be in the center.</p>	



MODE

● REPEAT MODE / SHUFFLE MODE (Page14)

: Available with multiple section, selected modes are activated on mode. operation.

▼ ex

Pressing lever to enter

And button for selection.

● INTRO MODE

Intro: Play beginning 10 seconds of each track.
Intro Highlight : play 10 seconds from the spot 1 minute played for each track.

● STUDY MODE

: 5 SEC/10 SEC : When you press STOP, it goes back 5 or 10 seconds. It will work as Interval repeat when you slide to +10/-10.

(For details on Study Mode, please refer to the next page)



Function Control(Playback Mode) SlimX™

● STUDY MODE

BEEP : This mode has been devised for the visually impaired. It allows the user to know each button's movement using a beep sound. The function itself is the same with 5 SEC MODE

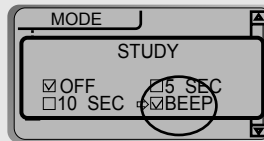

● BOOKMARK

Bookmark function is working under the study mode.

Long sliding of  to -10 to will add/delete/move the bookmark.

- Bookmark Add : Long sliding jog lever to -10 and clicking PROG/EQ button adds the present location into the bookmark.
- Bookmark Delete : Long sliding jog lever to -10 and clicking MODE/CD ↔ FM button deletes the present location from bookmark. Whenever you press Mode/CD ↔ FM button, the bookmark will be deleted in backward sequence.
- Moving to next bookmark : Long slide of -10 button and pressing ►► jog lever will move to next bookmark.
- Moving to previous bookmark : Long slide of -10 button and pressing ◄◄ jog lever will move to previous bookmark

Bookmarks can be reserved up to 20 in a disc.



Function Control(Playback Mode) SlimX™

● NAME

: You can input your name or text(maximum 12bytes).

▼ Button Operation

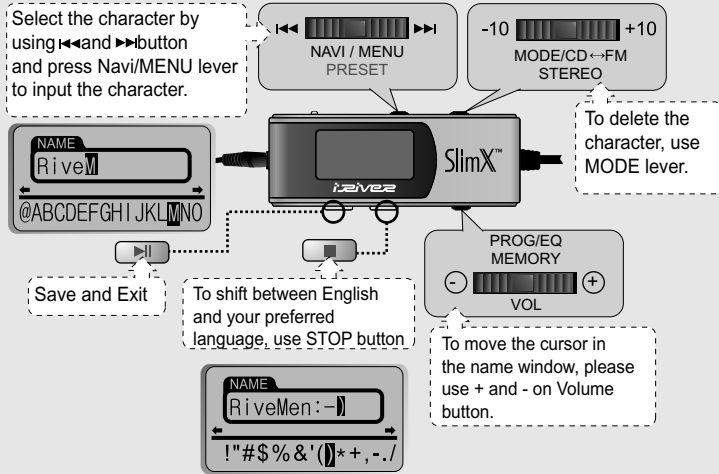

The saved text is displayed during initial loading of disc and at stop mode during play.

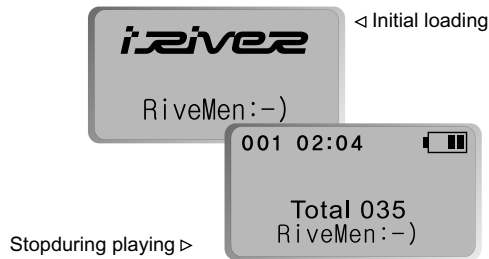

USER EQ

B.BOOST(BASS BOOST)

: Bass Boost lever is from 0 to 12dB.

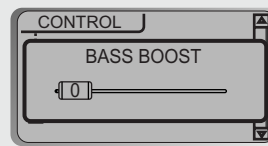

B.C.FREQ(BASS CORNER FREQUENCY)

: Bass Boost frequencies are 50Hz, 100Hz and 200Hz. Bass boost function is effective under the frequency range configured. Maximized at 200Hz.



T.BOOST(TREBLE BOOST)

: Treble boost level is from 0 to 12dB.

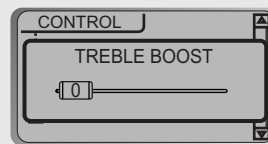

T.C.FREQ(TREBLE CORNER FREQUENCY)

: Treble boost frequencies are 2 kHz, 4kHz and 7 kHz. Treble boost function is effective over the frequency range configured. Maximized at 2kHz.



● USING WINAMP PLAYLIST

1) Build-Up WinAmp play list (*.M3U)

▼ Winamp Execution Screen

1. Execute WinAmp, add songs to build-up play list.

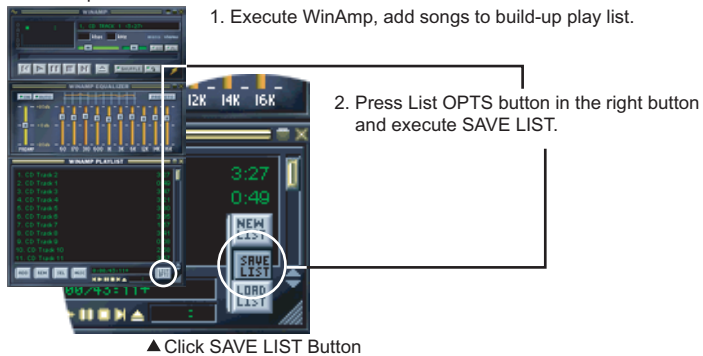

2. Press List OPTS button in the right button and execute SAVE LIST.

▲ Click SAVE LIST Button

3. Input file name(ex: iriver.3u) and press SAVE button to create new play list.

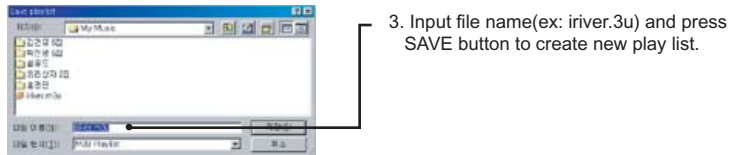

2) Burn the disc with WinAmp play list and related files.

3) Insert the disc into the player.

4) Press PROGRAM button at STOP mode displays LCD as in picture at right. USE [Left Arrow] to select play list wanted.

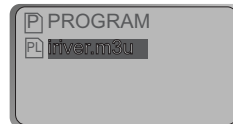

5) Pressing Navi/Menu or play button will play selected play list in sequential order.

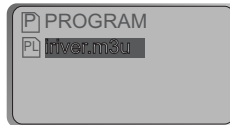

Icon stands for playback of play list ▶



6) Maximum 20 play lists within the disc can be recognized.



● RESERVATION FUNCTION

Press Navi/Menu button during playback and select the song to be reserved. Pressing PROG button reserves next song to be played.

ex ▼

Navi/Menu button during playback

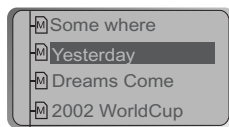
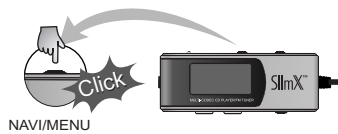

To select song, slide jog lever and



Power Supply(Adaptor) SlimX™

Using AC POWER ADAPTOR

- Use only AC Power Adaptor supplied with player.
- Connect the adaptor to 4.5V DC jack in the player and AC outlet.

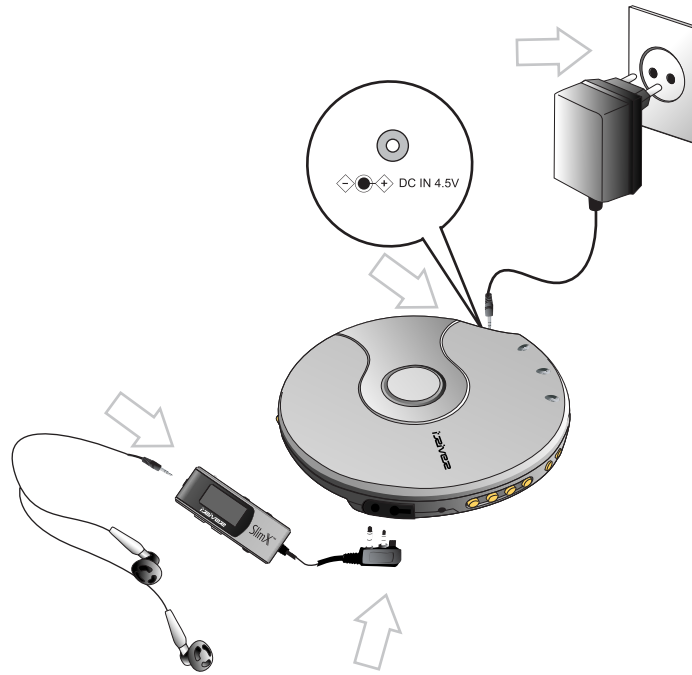

▷ Disconnect Adaptor when not in use.

● Using Rechargeable Batteries

- Open the cover of player and remove the covers of battery compartment.
- Insert two rechargeable batteries (stick type) by matching the + and - polarity diagram in the battery compartment and close the cover.

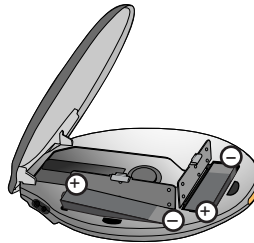

● Using External battery pack

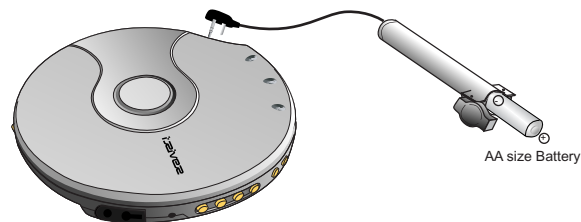

- The external battery pack can be attached as shown in the figure. Two AA size alkaline batteries are used in the external battery pack.

CAUTION!

- Do not mix rechargeable batteries with dry batteries.
- Do not use different types of rechargeable batteries together other than what comes with the console.
- When the batteries will not be used for a long time, remove them.
- If battery leakage occurs, wipe off any deposit in the battery compartment and install new batteries.



Power Supply(Rechargeable Batteries) SlimX™

Recharging Method

- Rechargeable function is available while the player has rechargeable batteries
- Power Off activates rechargeable function displaying Charge mode in LCD when plugged into AC adaptor.
- While in Charge Mode, long press of stop button turns the POWER OFF.

- 1) Install Rechargeable batteries.
- 2) Connect to Adaptor (During CD playing or Tuner playing, long pressing of STOP button shifts to charge mode.)
- 3) LCD

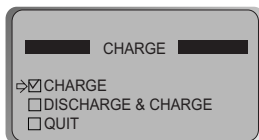

Menu movement is made by ◀◀, ▶▶ button and short clicking the stop button.
Batteries automatically begin charging after 1 minute passes without menu selection (when plugged into AC adaptor).

CHARGE : Charge without Discharge
DISCHARGE & CHARGE : Charge after full discharge
QUIT : Exit charge mode

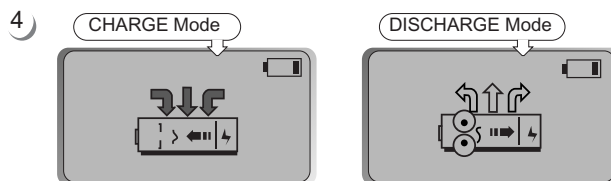

- 5) Automatically power off when charge is done.
- 6) Charging time (Estimated with the rechargeable stick batteries provided)
Charging : Approx. 6 hours (At full discharge)
Discharging : Approx. 5 hours (At full charge)

※ For long duration of battery life, please be advised to charge after complete discharge once a month.

— Trouble Shooting

SlimX™

Should any problem persist after you have checked these symptoms, consult your iRiver dealer.

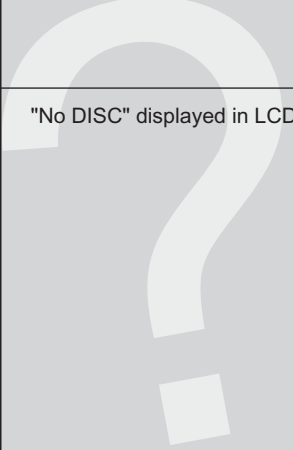
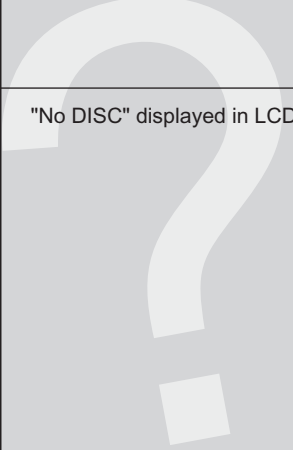
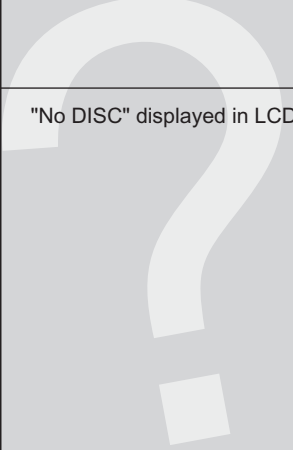
<p>No Power On</p> 	<ul style="list-style-type: none"> ● Check whether the batteries have been inserted in proper polarity. ● Check whether the HOLD switch in player or remote is ON (Switch to OFF position) ● Check whether the player lid is opened. ● Check whether the rechargeable batteries are not charged.
<p>"No DISC" displayed in LCD</p> 	<ul style="list-style-type: none"> ● Check whether CD is inserted. ● Check whether the CD is dirty or defective (clean it or change to new CD). ● Check whether the CD is inserted with the label side up. ● Check whether defects are attached in optical lens (remove the dirt with soft cloth). ● Check whether moisture condensation has occurred (leave the CD player aside for several hours until the moisture evaporates). ● Message may occur due to the characteristic deviation between CD-RW recorder and CD-R/RW disc (burn the disc with low speed). ● Use packet write disc with full formatting done.
<p>No Sound or noise is heard</p> 	<ul style="list-style-type: none"> ● Check whether VOLUME is set to "0". Connect the earphones/remote plug firmly. ● Check whether plug is dirty. Clean the plug with a dry and soft cloth. ● Corrupted MP3, WMA file may have a static noise or sound cut off. ● Continuous and excessive shock may keep the MP3, WMA and audio CD disc from proper playback.

Trouble Shooting SlimX™

Should any problem persist after you have checked these symptoms, consult your iRiver dealer.

AC adaptor does not work.	<ul style="list-style-type: none"> ● Check whether the plug is connected to proper jack.
Remote control does not work.	<ul style="list-style-type: none"> ● Check whether the HOLD switch is ON(Switch to OFF position.) ● Connect the earphones/remote plug firmly.
Battery lifetime differs	<ul style="list-style-type: none"> ● Check whether the player is using appropriate rechargeable batteries. ● Check whether the player is using non-fully charged batteries.
Characters in LCD are corrupted.	<ul style="list-style-type: none"> ● Check out Menu → Display → Language and confirm whether the right language has been selected.
FM is not heard well.	<ul style="list-style-type: none"> ● Adjust the position of the player and remote control. ● Turn off the power of other electric devices nearby the player. If it does work, please move away the player and work it from a distance. Remote control does function as the antenna.
Recharging does not work.	<ul style="list-style-type: none"> ● Check whether the adaptor plug is properly connected.



● Disc

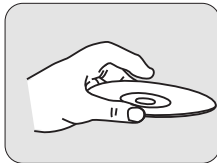

On Handling Disc

Avoid touching the surface(bright side) where data is stored.

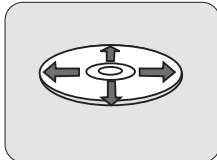

Disc Cleaning

Avoid cleaning the disc surface. If inevitable, clean with soft cloth in directions described.

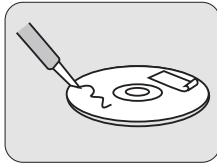

Do not stick papers or tape labels onto the surface(bright side).

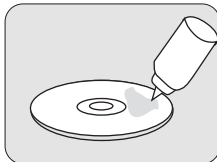

Avoid using chemicals to clean the surface.

● On Safety

- Should any solid objects or liquid fall into the console, unplug it and have it checked by qualified personnel before operating it any further. Do not put objects in the DC IN 4.5V jack(External Power output).
- Use only the suitable adapter provided with the player.



● On Player

- Keep the lens on the console clean and do not touch it. If you do so, the lens may be damaged and the console will not operate properly.
- Do not put any heavy object on top of the console. The console and the CD may be damaged.
- Do not leave the console in a location near heat sources, or in a place subject to direct sunlight, excessive dust or sand, moisture, rain, mechanical shock, unlevelled surface, or in a car with its windows closed.
- If the console causes interference to the radio or television reception, turn off the console or move it away from the radio or television.

● On Headphones and Earphones

- Road Safety
Do not use headphones/earphones while driving, cycling, or operating any motorized vehicle. It may create a traffic hazard and is illegal in some areas. It can also be potentially dangerous to play your headsets at high volume while walking, especially at pedestrian crossings. You should exercise extreme caution or discontinue use in potentially hazardous situations.
- Preventing hearing damage
Avoid using headphones/earphones at high volume. Hearing experts advise against continuously loud and extended play. If you experience a ringing in your ears, reduce volume or discontinue use.
- Consideration for others
Keep the volume at a moderate level. This will allow you to hear outside sound and to be considerate to the people around you.

- During playback, CDs damaged with dirt or a scratch may make a pop sound, clipping sound, or cut off.
- Tracks with damaged or corrupted parts are skipped or forwarded to next track.
- Playback files with extension MP3, WMA, ASF.
- Directories and files are sorted in alphabetical order.
Use the Navigation mode to select the tracks wanted.
- A total of 255 directories and 999 tracks within a disc can be recognized.
- Track information is displayed by filename or ID3 Tag information.
- CD-TEXT disc are displayed with track names within the TOC (Table of contents) of the disc.
- Maximum lifetime of the rechargeable batteries is 23 hours with external battery pack.
- Battery lifetime indicator may vary depending on the battery type and operation mode(CD/FM/Charge).



1 Remote control



2 Earphone and Earphone Sponge

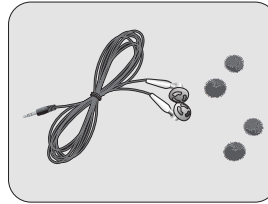

3 AC Adaptor

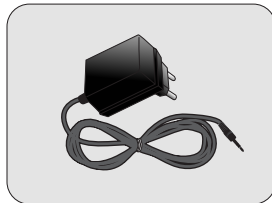

4 Rechargeable batteries (2 EA)

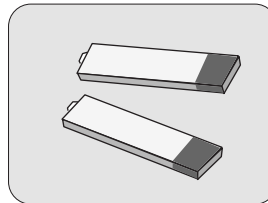

5 User manual/Warranty card

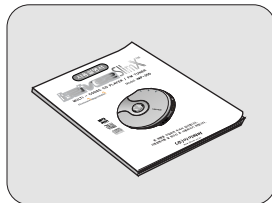

6 Carrying Case



7 External battery pack

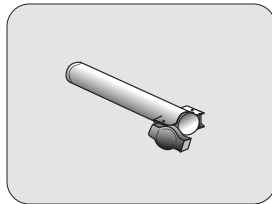

Product Specifications

SlimX™

Category	ITEM	Specifications
Audio (CD)	Frequency/Range	20Hz~20KHz
	Headphone output	12mW(L)+12mW at (16 Ω)Max. Volume
	Line Out Level	0.57V rms(47K Ω) at Max. Volume
	S/N ratio	90dB(CD-DA), 90dB(MP3 CD)
	Frequency Characteristics	\pm 2dB(Lineout)
	NO of channels	STEREO(L+R)
Audio (FM TUNER)	Frequency Range	87.5MHz~108MHz
	Headphone output	12mW(L)+12mW at (16 Ω)Max. Volume
	Lineout Level	0.55V rms(47K Ω) at Max. Volume
	S/N Ratio	57dB
	Receiver Type	Headphone/Earphone Cord Antenna
CD SUPPORT	CD Type	CD-DA, CD-Text(8cm / 12cm) CD-ROM Mode 1, Mode 2 Form1 Enhanced CD, CD-Plus
	CD-R/RW Readability	Packet Write, ISO9660, Joliet, Romeo, Multi-Session
FILE SUPPORT	File TYPE	MPEG 1/2/2.5 Layer 3, WMA ,ASF
	Bit Rate	Support 8Kbps ~ 320 Kbps
	Tag	ID3 V1 , ID3 V2 2.0, ID3 V2 3.0
POWER SUPPLY	AC adapter	DC 4.5V , 300mA
	Rechargeable battery	STICK type Ni-Mh battery 2 EA
	External Battery pack	Two 1.5V AA Size batteries
GENERAL	Dimension	Approx. 135(W) x 145(L) x 16.7(H)mm
	Weight	Approx. 189g(Excluding batteries)
	Operational Temperature	0 $^{\circ}$ C ~ 40 $^{\circ}$ C



Regulatory Information

● Federal Communications Commission(FCC)

The device manufactured and found to comply with limits for a Class B computing device according to the specifications in FCC rules Part 15. Operation is subject to the following two conditions;

1. This device may not cause harmful interference, and
2. This device must accept any interference received, including interference that may cause undesired operation.
3. If your device needs repairs, you must arrange for the manufacturer to make them if you are to keep the device's FCC registration valid.

This equipment, like other electronic equipment, generates and uses radio frequency energy. If not installed and used according to the instructions in this manual, this equipment may cause interference with your radio and television reception.

If you think this equipment is causing interference with your radio or television reception, try turning the equipment off and on. If the interference problems stop when the equipment is switched off, then the equipment is probably causing the interference. You may be able to correct the problem by doing one or more of the following:

- Adjust the position of the radio or TV antenna
- Move the device away from the radio or TV

If necessary, consult your dealer or an experienced radio or television technician. You may find this booklet helpful: "How to Identify and Resolve Radio and TV Interference Problems"(Stock No. 004-000-00345-4), prepared by the FCC and available from the U.S Government Printing Office, Washington, DC 20402. See individual devices FCC ID and registration numbers.

● For the customers in Europe



The CE mark on the CD player is valid only for products marketed in the European Union.



Safety Warning

CLASS 1 LASER PRODUCT
KLASSE 1 LASER PRODUKT
LUOKAN 1 LASER LAITE
KLASS 1 LASER APPARAT
PRODUCTO LASER CLASE 1

Use of controls, adjustments or performance of procedures other than those specified herein may result in hazardous radiation exposure.
CAUTION-INVISIBLE LASER RADIATION WHEN OPEN AND INTER LOCKS DEFEATED, AVOID EXPOSURE TO BEAM.

WARNING

- To prevent fire or shock hazard, do not expose the unit to rain or moisture.
- To avoid electrical shock, do not open the cabinet. Refer servicing to qualified personnel only.
- Certain countries may regulate disposal of the battery used to power this product. Please consult with your local authority.
- Listening for many hours at maximum volume may damage your hearing.



***iRiver* SlimX™**
Model iMP-350

***iRiver* Limited**
<http://www.iRiver.com>