

Quick Start Guide

Smart
Phone

1. What's in the Box?



2. Your Phone at a Glance

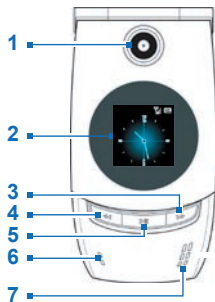

- 1. Camera Lens** 1.3 Mega-pixel CMOS lens on the flip cover. It supports the self-capturing feature from the external screen when the flip cover is closed.
- 2. External Screen** When your phone is powered on and the flip cover is closed, the external screen shows the device status.
- 3. Forward** When Media Player is running, press this hotkey to jump to the next file. If Media Player is launched in foreground but no file is loaded, nothing happens when you press this hotkey.
- 4. Rewind** When Media Player is running, press this hotkey to go back to the beginning of the current file; quickly press twice to jump to the previous file. If Media Player is launched in foreground but no file is loaded, nothing happens when you press this hotkey.
- 5. Play/Pause** When the flip cover is closed, press this hotkey to launch Windows Media Player directly.
- 6. LED Indicators** The upper bi-color LED Indicator (amber/red/green) notifies you of the battery and network status of your phone respectively, while the lower blue LED indicator notifies you of Bluetooth connectivity status. For more information about LED Indicators, see the table at the end of this section.
- 7. Speaker** Listen to audio media.

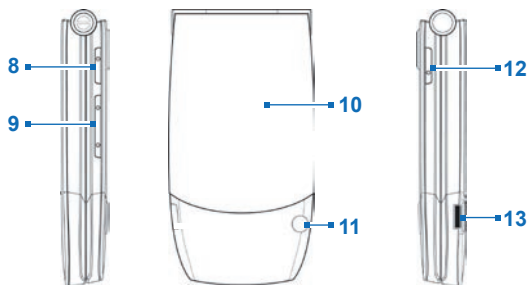

- 8. Voice Notes/
Voice Tag** Long press to launch Voice Notes recorder. Short press to launch Voice Tag feature. Please note the button does not work when the flip cover is closed.
- 9. Volume** Press to increase or decrease the earpiece volume during a call.
- 10. Battery Cover**
- 11. External Antenna
Connector** Connect your phone to an external antenna (if available) to utilize the superior reception quality.
- 12. Camera** Press to launch the camera. If already running, press to capture an image or start recording a video clip.
- 13. Earphone/
Sync Connector** Connect the USB cable to synchronize data or recharge the battery; or, plug the provided Stereo headset to use the hands-free kit or listen to audio media.



- 14. Earpiece** Listen to a phone call.
- 15. Display Screen**
- 16. Left Soft Key** Press to perform the command shown in the label above the button.
- 17. TALK** Press to dial a phone number, answer a call, switch to another call, or put a call on hold. Hold to activate/deactivate loudspeaker mode.
- 18. HOME** Press to go to the Home Screen. Press and hold to open the Quick List.
- 19. *T9 Key** Press and switch to different input modes or press and hold to choose an input mode or symbols from the list.
- 20. Light Sensor** Dark conditions sensed here will activate a backlight under the keypad, making it easier to see the buttons.
- 21. Right Soft Key** Press to perform the command shown in the label above the button.
- 22. Power/END** Press and hold to turn on/off the phone. Or during a call, press to end the call.
- 23. Back** Press to go to the previous screen, or backspace over characters.
- 24. Navigation Control/ENTER** Use to scroll left, right, up, or down. Or press straight down to use as the ENTER button.
- 25. _# Key** Press to add a space or press and hold to display a list of symbols.
- 26. Microphone** Speak into the microphone when receiving or making a phone call or voice recording.

LED indicator lights

Various colors that might display in the two LED Indicators are summarized here.

Upper LED	Status
Solid green	Battery is fully charged.
Blank	Device is powered off, device in flight mode or no network coverage.
Solid amber	Battery is charging or the phone is using ActiveSync to synchronize with a PC.
Flashing green	Connected to the network.
Flashing red	Battery very low (less than 4%).
Flashing amber	Battery temperature is hotter or colder than the functional limits of 0 to 48 degrees Celsius, and has stopped charging.
Amber/Green LED off	Battery fault. The "Battery Fault" indicator () is displayed. In this case, the flashing green LED can be recovered by unplugging the AC adapter.
Dim	Disconnected from the network.

Lower LED	Status
Flashing blue	Bluetooth mode set to "On" or "Discoverable" mode.

3. Set Up Your Phone in 6 Steps

1 Install the SIM card

Your SIM (Subscriber Identity Module) card is given to you by your wireless service provider and contains your basic subscriber information, such as your phone number and your address book.

Before you begin, ensure that the phone is turned off.

- 1. Open the battery cover:** Hold the phone in one hand with the front panel facing down in the palm of your hand. The other hand press down on the battery cover and slide it open.
- 2. Insert the SIM card:** Insert the SIM card into the SIM card slot with its gold contacts facing down. When completed, replace the battery cover.

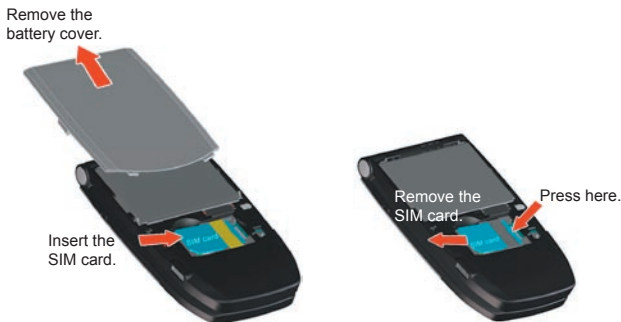

To take the SIM card out, press the bottom of the SIM card to slide it out of the slot. Then lightly lift up the SIM card.

2 Install the Micro SD card

Use a Mini-SD (Secure Digital) card in your phone to store images, video clips, music, and other data you may have obtained.

1. Open the battery cover.
2. Remove the SIM card if you have installed.
3. Lift up the Micro SD card metal socket, and insert the Micro SD card into the slot.
4. Push the metal socket down.
5. Replace the SIM card, battery and battery cover.

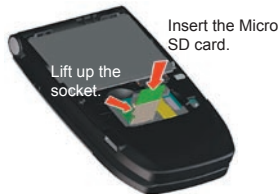

3 Install and charge the battery

New batteries are shipped partially charged. Before you can use your phone, you need to install and charge the battery. To install the battery, remove the battery cover first, and then insert the battery by aligning the exposed copper part of the battery pack with the protruding copper conductor of the battery slot. Insert the bottom side of the battery first, then gently push the battery into place, and replace the battery cover.

Some batteries perform best after several full charge/discharge cycles. You can charge the battery in two ways:

- Connect your phone directly to an electrical outlet using the AC adapter.
- Connect your phone to the USB port on your PC and using the USB cable.

4 Turn on your phone

Open your phone and locate the POWER/END button. Press and hold the button to turn on the phone.



POWER/END button

5 Install ActiveSync

ActiveSync synchronizes information between your phone and your PC, keeping information up to date in both devices. Before you connect your phone to your PC, you must install ActiveSync on the PC. ActiveSync is already installed on your phone.

1. Insert the Getting Started CD into the CD drive of your PC.
2. Follow the instructions on the installation wizard screen to install ActiveSync.
3. Connect the USB cable to the phone and plug it into the USB port of your PC.
4. Turn on your phone. When the PC detects a USB connection, it starts the ActiveSync Synchronization Setup Wizard. Follow the instructions on the screen and select the items you want to synchronize.

6 Make your first phone call

Before you make a phone call, ensure that a SIM card is installed and the battery is sufficiently charged.

- To make a call, enter the phone number by pressing keys on the keypad and press TALK (📞).
- To end a call, press END (📞).

4. Set Up an E-mail Account and Send a Message

Your phone can be set up to retrieve e-mails from Outlook e-mail, Hotmail, POP3 and IMAP4 accounts. However, you need to set up your e-mail account with an Internet service provider (ISP) or an account that you access using a VPN server connection (typically a work account) before you can send and receive mail.

To set up a POP3/IMAP4 e-mail account

1. On the Home screen, click **Start > Messaging** and select Outlook E-Mail.
2. Click **Menu > Options > New Account**.
3. In **Your name**, enter your display name for e-mail messages.
4. In **E-mail address**, enter the e-mail address for this account.
5. Select **Attempt to obtain e-mail settings from the Internet** and click **Next**.
6. **Auto Setup** will help you download necessary e-mail server settings. When completed, click **Finish**.

To send an e-mail message

1. On the Home screen, click **Start > Messaging**.
2. Select an e-mail account, or select **Text Messages**. Then, click **Select**.
3. Click **New**.
4. Enter the e-mail address or phone number of one or more recipients, separating them with a semicolon (;). To access addresses and phone numbers from Contacts, in **To**, press ENTER and select a recipient from the list.
5. Enter a message.
6. Click **Send**.

5. Browse the Web

Your phone comes with Internet Explorer Mobile installed. Internet Explorer Mobile is a fullfeatured Internet browser, optimized for use on your phone.

You can also use ActiveSync to synchronize the Internet Explorer favorites on your PC with your phone so you can use them with Internet Explorer Mobile as well. For more information, see ActiveSync Help on your PC.

To open Internet Explorer

- On the Home screen, click **Start > Internet Explorer**.

6. Take a Picture and Send It

Taking photos and shooting video clips with audio is easy with your phone's built-in camera. To open Camera or Video Recorder, do any of the following:

- On the Home screen, click **Start > Camera**.
- On the Home screen, click **Start > Video Recorder**.
- Press the CAMERA button on your phone.

To exit Camera or Video Recorder, press END (.

To capture a still image

- On the Camera [Photo] screen, click **Capture**.
- Press the CAMERA button or the ENTER button on your phone.

To record a video clip

- On the Camera [Video] screen, click **Capture**.
- Press the CAMERA button or the ENTER button to start recording a video clip. To stop recording, click **Stop** on the Camera screen. You can also press ENTER or CAMERA again to stop recording.

To send pictures and video clips from the Camera program

1. Capture an image or a video clip using the Camera program.
2. On the Review screen, click the Send icon () to send the file via e-mail or MMS.

If the message is to be sent to an e-mail address, it will be sent the next time you synchronize your phone. If you send an MMS message to a mobile phone, it will be immediately sent.

To use the Pictures & Videos program

- Click **Start > Pictures & Videos**.
- After capturing image, click the View icon () on the Review screen to switch to Pictures & Videos.

The Pictures & Videos program allows you to view pictures and play video clips on your phone, and even view the pictures as a slide show, beam them, send them via a messaging program, edit them, or set them as the background on the Home Screen.

To send pictures and video clips from the Pictures & Videos program

1. On the Pictures & Videos screen, select the item you want to send.
2. Click **Menu > Send**.
3. On the Messaging screen, select Outlook E-mail, MMS, or a custom e-mail account. A new message is created with the item attached.
4. Enter the recipient name and subject, and click **Send**.

7. Personalizing Your Phone

To set up the Answer Mode

You can answer an incoming call by pressing TALK (📞) or any numeric key on the keypad, or simply by opening the flip cover.

1. On the Home screen, click **Start > Settings > Phone**.
2. Click **Answer Mode**.
3. Select **Open to answer** or **Any key to answer**.

To set up the Home screen

The Home screen is your starting place for most tasks. You can gain access to all features and programs from the Home screen.

1. On the Home screen, click **Start > Settings > Home Screen**.
2. Click **Disable SIM PIN**.
3. In **Home screen layout**, **Color scheme**, **Background image**, and **Time out**, select the options you want, and click **Done**.

To set language, locale, and other regional options

Your phone should already be set up with the regional settings that are appropriate for your locale. However, you can specify the language, locale, date and time style, as well as number and currency formatting options by doing the following:

1. On the Home screen, click **Start > Settings > Regional Settings**.
2. In **Language**, select your preferred language.
3. In **Locale**, select the locale for the language you selected. The Locale option automatically changes the format of the remaining options (such as date, time, and currency) according to the locale you specify. Then, click **Done**.

Note You must turn your phone off and on again for the changes to take effect.

To set the date and time

Your phone should already be set up with the regional settings that are appropriate for your locale. However, you can specify the language, locale, date and time style, as well as number and currency formatting options by doing the following:

1. On the Home screen, click **Start > Settings > Clock & Alarm > Date and Time**.
2. In **Time zone**, select your time zone.
3. In **Date**, edit the month, day, or year.
4. In **Time**, edit the hour, minute, and second.
5. Click **Done**.

To set an alarm

Your phone should already be set up with the regional settings that are appropriate for your locale. However, you can specify the language, locale, date and time style, as well as number and currency formatting options by doing the following:

1. On the Home screen, click **Start > Settings > Clock & Alarm > Alarm**.
2. In **Alarm**, choose **Off/On** to turn the alarm off/on.
3. In **Alarm time**, enter the time for the alarm to go off.
4. Click **Done**.

8. Secure Your Phone

There are several levels of security on your phone. You can protect your phone from unauthorized use by requiring a type of password called a PIN (personal identification number) in order to make calls. Your first PIN will be given to you by your wireless service provider. Additionally, you can lock the entire phone to prevent unauthorized access.

To enable the SIM PIN (Personal Identification Number)

1. On the Home screen, click **Start > Settings > Security**.
2. Click **Enable SIM PIN**.
3. Enter your PIN, and click **Done**.

Note To cancel without enabling the SIM PIN, press HOME.

To disable the SIM PIN

1. On the Home screen, click **Start > Settings > Security**.
2. Click **Disable SIM PIN**.
3. Enter your PIN, and click **Done**.

To lock/unlock the keypad

Locking the keypad turns off keypad functionality. This is a helpful feature if, for example, the phone is turned on and in your pocket, and you want to prevent accidental keypresses.

On the Home screen, press and hold the HOME button, and click **Key lock**. Once the keypad is locked, the left soft key label changes to **Unlock**.

When the keypad is locked, click **Unlock** and press the **★ TS** key to unlock the keypad.

Note You can still receive calls and make emergency calls when the keypad is locked.

To enable/disable Device Lock

Device Lock is an additional security feature that prevents unauthorized use of your phone. To enable the function:

1. On the Home screen, click **Start > Settings > Security**.
2. Click **Device Lock**.
3. Select the **Prompt if device unused for** item, then select the amount of time for the phone to be inactive before automatically locking.
4. Select the Password type (**Simple PIN** or **Strong alphanumeric**).
5. Enter and confirm your password.
6. Click **Done**.

To disable Device Lock, click **Start > Settings > Security > Device Lock** to enter the setting page (require the password) and clear the **Prompt if device unused for** item.

Once you configure the Device Lock setting, you can lock your phone from the Quick List directly without configuring the settings again.

When the device is locked, click **Unlock** and enter the password to unlock your device.

9. Learn More

For more in-depth instructions refer to the User Manual, or look for information on Microsoft® Windows Mobile™ Web site (<http://www.microsoft.com/windowsmobile/smartphone/>).