Nokia 206 Dual SIM User Guide

Contents

Keys and parts.....	5
Insert a SIM card and battery.....	7
Insert a second SIM card.....	8
Insert a memory card.....	9
Charge the battery.....	9
Lock the keys	10
Explore your phone.....	10
Set which SIM card to use.....	11
Copy content from your old phone.....	12
Icons shown on your phone.....	14
Make or answer a call.....	15
Call the last dialled number.....	16
View your missed calls.....	16
Change the volume.....	17
Save a name and phone number.....	17
Make calls quickly.....	19
Send a message.....	20
Write text.....	21

Check your voicemail.....	22
Personalise your home screen.....	23
Add shortcuts to your home screen.....	24
Change your ringtone.....	25
Set an alarm.....	26
Add an appointment.....	27
Listen to the radio.....	28
Play a song.....	29
Take a photo.....	30
Record a video.....	31
Browse the web.....	32
Add a bookmark.....	33
Set up your mail account.....	33
Send a mail.....	34
Set up chat in your phone.....	35
Chat with your friends.....	36
Send a photo using Bluetooth.....	37
Share using Nokia Slam.....	38

Restore original settings.....	39
Update phone software using your phone.....	40
Back up content to a memory card.....	41
Access codes.....	42
Support.....	44
General information.....	45

Keys and parts



- 1 Charger connector
- 2 Headset connector (3.5 mm)
- 3 Screen

- 4 Scroll key
- 5 End/Power key
- 6 Keypad

- 7 Microphone
- 8 Call key

- 9 Selection keys
- 10 Earpiece

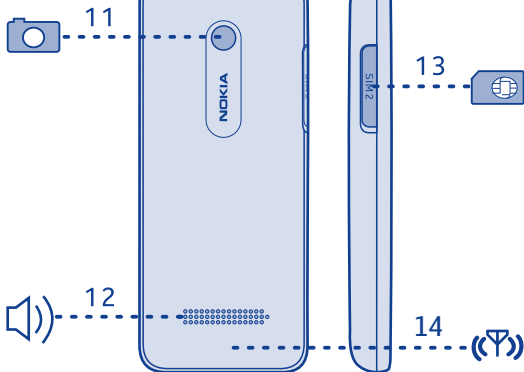

Your phone uses S40 software.

- 11 Camera lens. Before using the camera, remove the protective tape from the lens.
- 12 Loudspeaker
- 13 SIM card slot (SIM 2)
- 14 Antenna area. See  1 in "Feature-specific instructions".

Insert a SIM card and battery

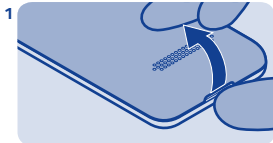

Switch the phone off, and remove the back cover.



Line up the battery contacts, and push the battery in.

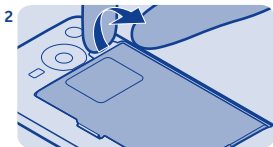

If the battery is in the phone, lift it out.



Press the back cover down until it locks into place.



Lift the SIM holder, and put the SIM in, contact area face down. See  3.



To switch on, press and hold  until the phone vibrates.

Insert a second SIM card



Open the **SIM 2** SIM cover. See ➔ 6.



To remove the card, open the **SIM 2** SIM cover.



Put the SIM in, contact area face up.

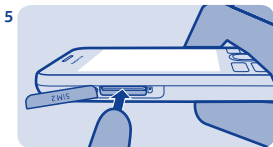

Push the SIM in until it's free.

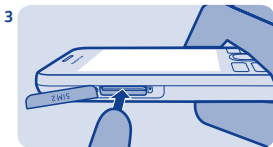

Push the card in until it locks into place. Close the cover.

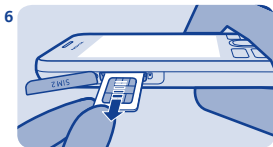

Pull the SIM out.

Insert a memory card

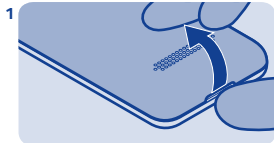

Switch the phone off, and remove the back cover.

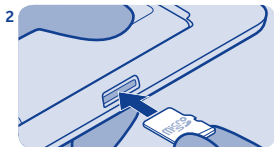

Push the card in, contact area face down, until it locks into place.



Press the back cover down until it locks into place. See ➡ 2.

Charge the battery

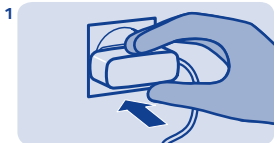

Plug the charger into a wall outlet.



Connect the charger to the phone. See ➡ 4.



Battery full? Unplug from the phone, then from the wall outlet.

Lock the keys



Lock the keys when not using your phone.

Explore your phone



To see the features and apps in your phone, press **Menu**.



Select **Menu**, then press *****.



To go to an app or feature, press the scroll key up, down, left, or right.



To unlock, select **Unlock**, then press *****.



To open the app or select the feature, press **Select**.

Set which SIM card to use



To go back to the previous view, press **Back**.



Set the SIM for outgoing calls, messages, and connections.



To go back to the home screen, press **⓪**.

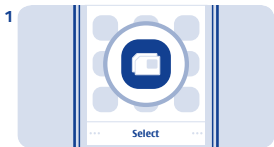

Select **Menu** > **SIM manager**.



To decide every time which SIM to use, select **Ask every time**.

Copy content from your old phone



Select **SIM1** or **SIM2** to set which SIM to use for which connection.



Easily get your contacts, calendar, and other stuff to your new phone.

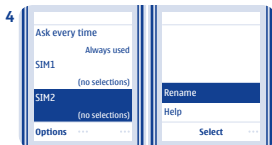

To rename a SIM, select the card, and select **Options** > **Rename**.



Switch Bluetooth on in both phones.



Write a name, and select **OK**.

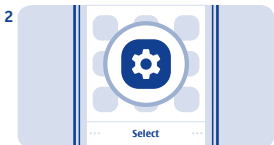

Select **Menu** > **Settings**.

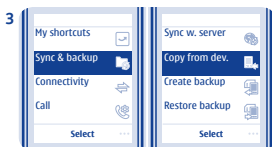

Select **Sync & backup** > **Copy from dev..**

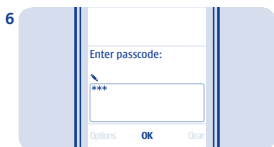

If asked, create a one-time passcode (such as 123), and select **OK**.

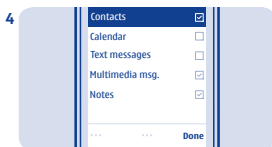

Select what you want to copy, and select **Done**.



Check that the codes match on both phones.

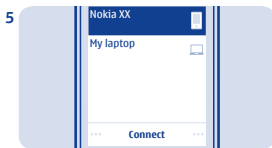

Select your old phone from the list of found devices.





Follow the instructions shown on both phones.

Icons shown on your phone

 — You have unread messages sent to SIM1 or SIM2.

 — You have unread messages sent to SIM1 and SIM2.

 — You have unsent or failed messages from SIM1 or SIM2.

 — You have unsent or failed messages from SIM1 and SIM2.

 — The keys are locked.

 — The phone doesn't ring when somebody calls or sends a message.

 — An alarm is set.

 — Bluetooth is on.

 — All incoming calls to SIM1 or SIM2 are forwarded to another number.

 — All incoming calls to SIM1 and SIM2 are forwarded to another number.

 — A headset is connected to the phone.

The type of mobile network you're currently connected to may be shown with a single letter, a combination of letters, or a combination of letters and numbers. For example, , depending on your network service provider.

The icons may vary depending on your region or network service provider.

Make or answer a call



Call your friend. See [▶ 15](#).



To end the call, press [⏏](#).



1 Type in the phone number, and press [⏏](#).

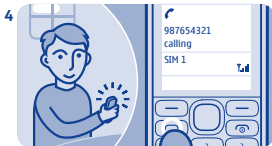

4 When your phone rings, press [⏏](#) to answer. See [▶ 16](#).

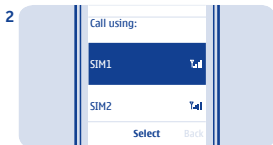

2 If asked, select which SIM to use.

Call the last dialed number



On the home screen, press .



Select the number, and press .

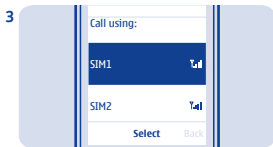

If asked, select which SIM to use.

View your missed calls

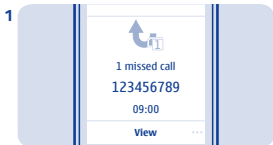

On the home screen, select **View**. See  5.



To call back, select the number, and press .

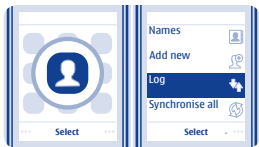

Tip: To view missed calls later, select **Menu > Contacts > Log > Missed calls**.

Change the volume



Is the volume too loud during a call or when listening to the radio?



Scroll up or down.



Better.

Save a name and phone number



Add new contacts to your phone.

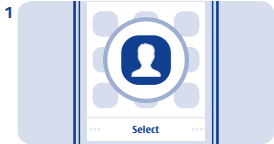

Select **Menu** > **Contacts**.

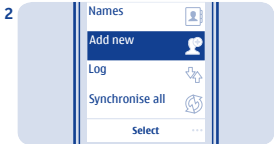

Select **Add new**. If asked, select where to save the contact.



Type in the phone number, then select **OK**.



To search for a contact, start writing the contact's name in the search box.

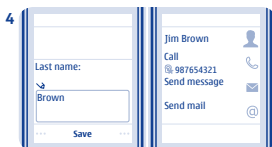

Write the first and last name, then select **Save**.

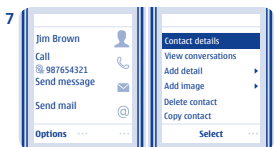

Select **Options** > **Contact details**.

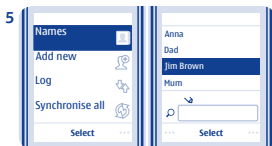

To edit details, select **Names** and a contact.

Make calls quickly

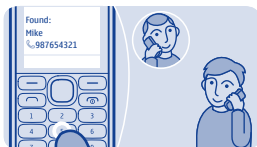

Call someone often? Set their number as a speed dial. See [7](#).

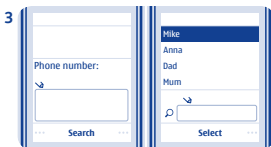

Select **Search** and a contact.

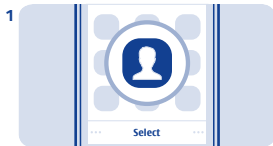

Select **Menu** > **Contacts**.

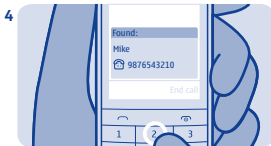

To call, press and hold a number key on the home screen.

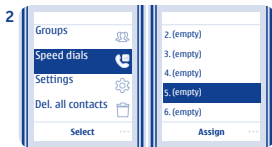

Select **More** > **Speed dials** and a free slot, then select **Assign**.

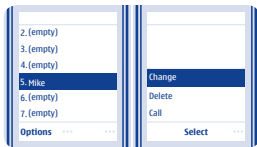

Tip: To change a speed dial, select **Options** > **Change**.

Send a message

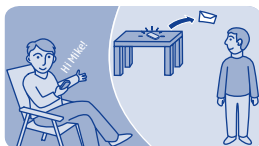

Keep in touch with people through messages. See  9.



Write your message.

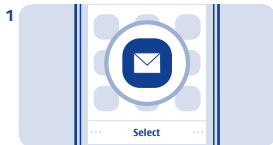

Select **Menu** > **Messaging**.

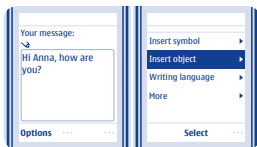

Tip: To add an attachment, select **Options** > **Insert object**. See  10, 11.

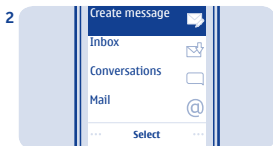

Select **Create message**.

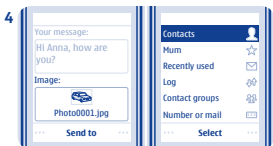

To add a recipient, select **Send to** > **Contacts**.

Write text

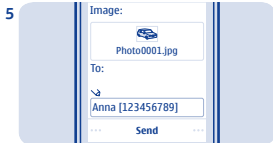

Select **Send**. If asked, select which SIM to use. See [12, 11](#).

Press a key repeatedly until the letter is shown.

To type in a special character or a punctuation mark, press and hold *, and select the character.

To switch between character cases, press #.

To use number mode, press and hold #, and select **Number mode**. To go back to letter mode, press and hold #.

If you want to quickly type in a single number, just press and hold the number key.

To switch predictive text on or off, select **Options > Prediction**, and select **On** or **Off**. Not all languages are supported.

To change the writing language, select **Options > Writing language**.

Check your voicemail



When you can't answer, you can forward calls to your voicemail.

3



When setting up voicemail, type in your voice mailbox number.

1



Select **Menu** > **Messaging**.

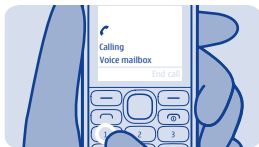

Tip: To quickly call your voicemail, press and hold **1** on the home screen.

2

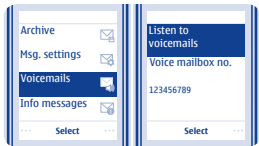

Select **More** > **Voicemails** > **Listen to voicemails**.

Personalise your home screen



You can change the wallpaper, and rearrange items on the home screen.

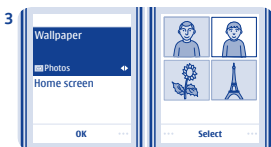

Select **OK** to open the folder, and select a photo.

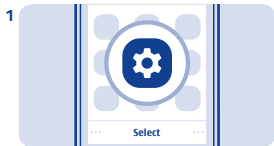

Select **Menu** > **Settings**.



Tip: You can also take a photo on your phone camera, and use that.

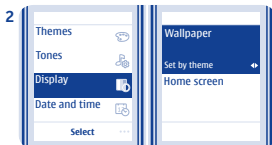

Select **Display**, scroll to **Wallpaper**, and scroll to a folder.

Add shortcuts to your home screen



Add shortcuts to your favourite apps to your home screen.

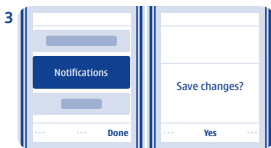

Select **Done** > **Yes**.



Scroll to a shortcut, then select **Options** > **Personalise view**.



Select a bar, then select an item, such as a widget.

Change your ringtone



Set a different ringtone for each profile and SIM card.

3

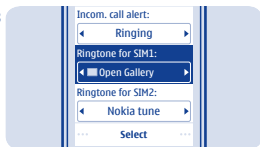

Scroll to **Open Gallery**, and select **Select**.

1



Select **Menu** > **Settings**.

4

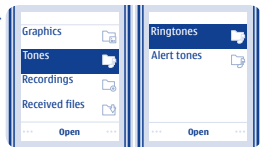

Select **Tones** > **Ringtones** and a ringtone.

2

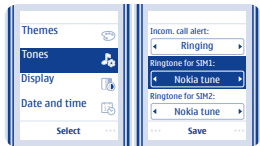

Select **Tones**, and scroll to the ringtone.

Set an alarm



Use your phone as an alarm clock.

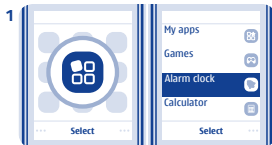

Select **Menu** > **Applications** > **Alarm clock**.

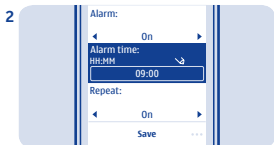

Select **Options** > **Add new alarm**, set the alarm time, and select **Save**.

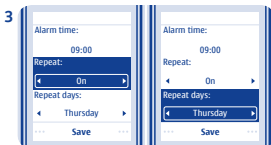

To repeat the alarm, set **Repeat:** to **On**, and select **Repeat days:** and the days and **Done**.

Add an appointment

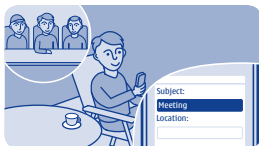

Need to remember an appointment?
Add it to your calendar.

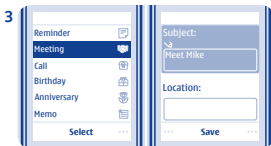

Select **Meeting**, fill in the fields, then
select **Save**.

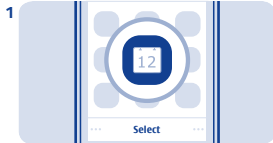

Select **Menu** > **Calendar**.

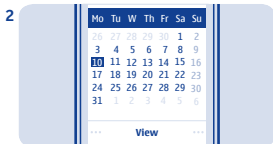

Select a date and **View** > **Add**.

Listen to the radio



Listen to your favourite radio stations on your phone.

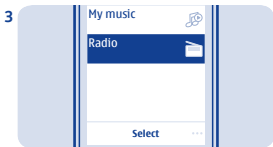

Select **Radio**.



Connect a compatible headset. It acts as an antenna.



To change the volume, scroll up or down.

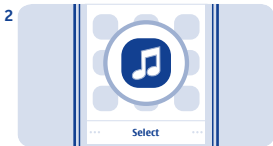

Select **Menu > Music**.



To close the radio, press .

Play a song



Listen to your favourite music on your phone.

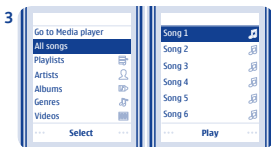

Select the song you want to play.

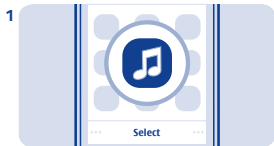

Select **Menu** > **Music**.

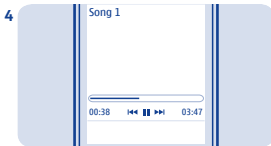

To pause or resume playing, press the scroll key.

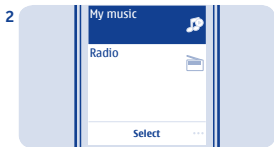

Select **My music**.



To close the music player, press .

Take a photo



There's a camera in your phone - just aim and snap!



3 Select  The photos are saved in My photos.

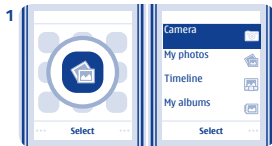

1 To open the camera, select **Menu > Photos > Camera**.



2 To zoom in or out, scroll up or down.

Record a video

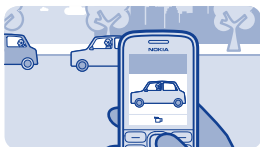

Besides taking photos, you can also record videos with your phone.

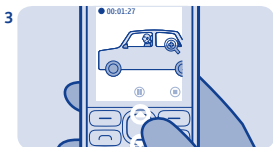

To zoom in or out, scroll up or down.

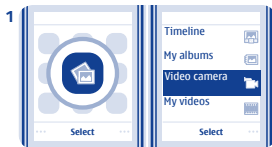

To open the camera, select **Menu** > **Photos** > **Video camera**.



To stop recording, select . Videos are saved in My videos.

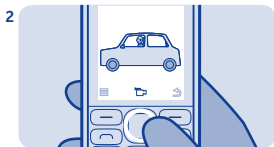

To start recording, select .

Browse the web



Catch up on the news, and visit your favourite websites.

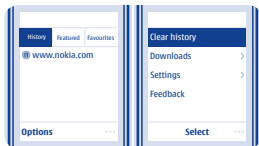

Tip: On the History tab, you can select **Options > Clear history**.

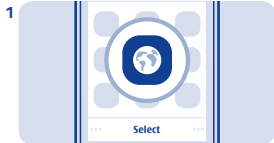

Select **Menu > Internet**.

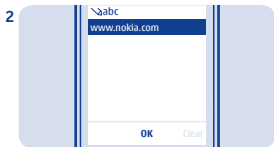

To go to a website, write the web address in the address bar.

Add a bookmark



If you visit the same websites often, add them as bookmarks.

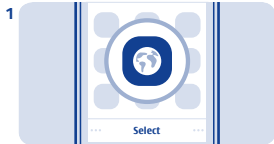

Select **Menu** > **Internet**.

Set up your mail account



Want to use mail, but don't have a computer? You can use your phone.

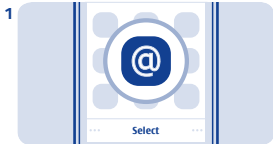

Select **Menu** > **Mail** or **Menu** > **Messaging** > **Mail**.

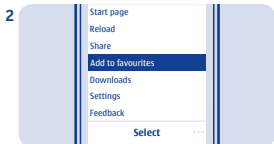

While browsing, select **Options** > **Add to favourites**.



Select a mail service, and sign in.

Send a mail

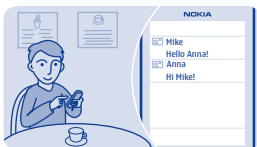

You can read and send mail while on the move.

3

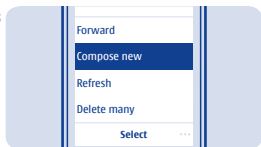

In the mailbox, select **Options** > **Compose new**.

1



Select **Menu** > **Mail** or **Menu** > **Messaging** > **Mail**. If asked, select which SIM to use.

4

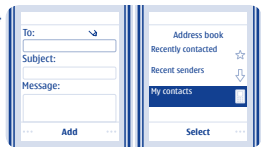

To add a recipient, select **Add**, or manually write the address.

2

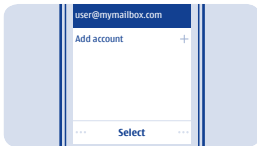

Select a mail account.

5

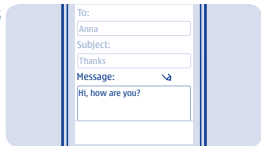

Write the subject and your message.

Set up chat in your phone

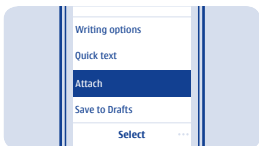

Tip: To attach a file, select **Options** > **Attach**.



Set up chat to keep in touch with your friends wherever you are.

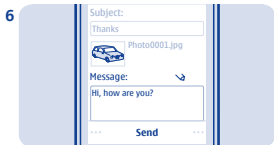

Select **Send**.

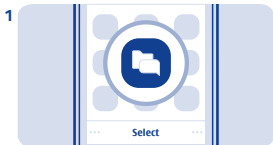

Select **Menu** > **Chat**. If asked, select which SIM to use.

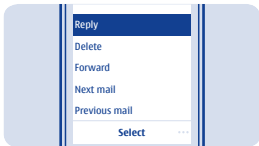

Tip: To reply to a mail, open the mail, and select **Options** > **Reply**.

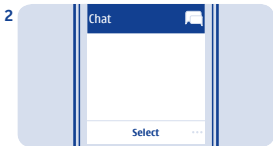

Select a service, and sign in.

Chat with your friends



You can chat with your friends online while on the move.

3

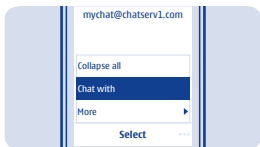

Select **Options** > **Chat with**.

1



Select **Menu** > **Chat**. If asked, select which SIM to use.

4

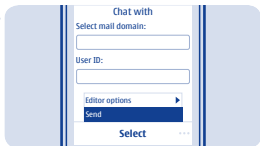

Select a chat service, write the username, and select **Options** > **Send**.

2



Select a chat account, and sign in.

5



Write your message in the text box, and select **Send**. See ➡ 8.

Send a photo using Bluetooth

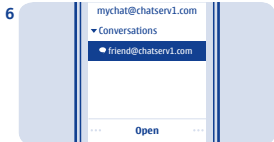

When you want to continue a conversation, select the thread.



Send a photo you have taken to your PC. See [13](#).

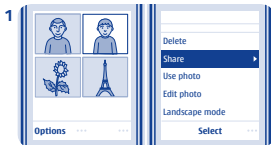

Select the photo and **Options** > **Share**.

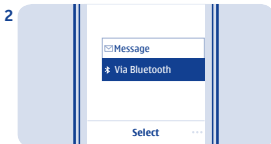

Select **Via Bluetooth**.

Share using Nokia Slam

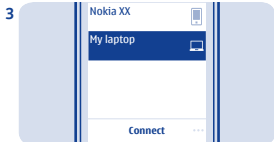

Select the device to connect to. If asked, type in the passcode.



Share your content easily with Nokia Slam.

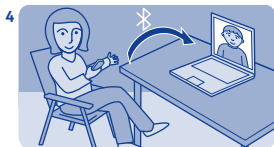

The photo is sent to your PC.



Switch Bluetooth on in both phones. Your phone must not be hidden.

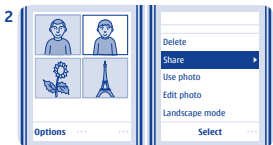

Select, for example, a photo to share, and **Options** > **Share**.

Restore original settings

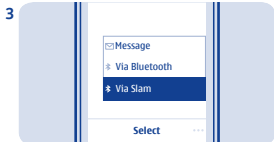

Select **Via Slam**.



If your phone is not working properly, reset the settings.



Move your phone close to the other phone.



End all calls and connections.



Nokia Slam searches for the nearest phone, and sends the item to it.

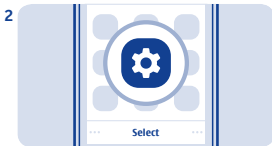

Select **Menu** > **Settings**.

Update phone software using your phone

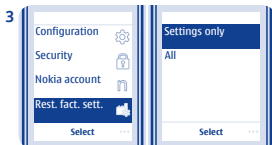

3 Select **Rest. fact. sett.** > **Settings only**.

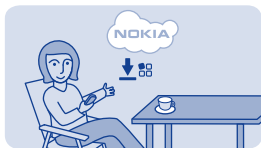

You can update your phone software wirelessly. You can also set your phone to automatically check for updates.

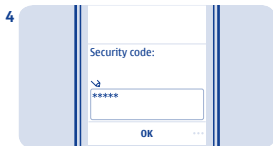

4 Type in the security code, then select **OK**.

You can only update your software when using the SIM in the internal SIM holder.

Select **Menu** > **Settings** and **Phone** > **Device updates**.

1. To check if there is an update, select **Downl. phone sw.**
2. To download and install an update, select **Downl. phone sw.**, and follow the instructions shown on the phone.

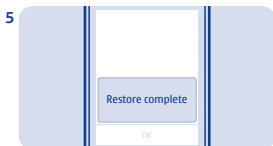

5 Your phone switches off and on again. This may take longer than usual. See

The update may take several minutes. If you encounter problems, contact your network service provider.

Check for updates automatically

Select **Auto sw update**, and set how often to check.

➔ 14.

Back up content to a memory card

Your network service provider may send updates over the air directly to your phone. For more info on this network service, contact your network service provider.



Want to make sure you won't lose any important files? You can back up your phone memory to a compatible memory card.

Select **Menu** > **Settings** > **Sync & backup**.

1. Select **Create backup**.
2. Select what you want to back up, then select **Done**.

Restore a backup

Select **Restore backup**.

Access codes

<p>PIN or PIN2 code (4-8 digits)</p>	<p>These protect your SIM against unauthorised use or are required to access some features.</p> <p>You can set your phone to ask for the PIN code when you switch it on.</p> <p>If not supplied with your card or you forget the codes, contact your service provider.</p> <p>If you type in the code incorrectly three times in a row, you need to unblock the code with the PUK or PUK2 code.</p>
<p>PUK or PUK2 code (8 digits)</p>	<p>These are required to unblock a PIN or PIN2 code.</p> <p>If not supplied with your SIM, contact your service provider.</p>
<p>IMEI number (15 digits)</p>	<p>This is used to identify valid phones in the network. The number can also be used to block, for example, stolen phones. You may also need to give the number to Nokia Care services.</p> <p>To view your IMEI number, dial *#06#.</p>
<p>Lock code (security code) (min. 5 digits)</p>	<p>This helps you protect your phone against unauthorised use.</p> <p>You can set your phone to ask for the lock code that you define. The default lock code is 12345.</p> <p>Keep the code secret and in a safe place, separate from your phone.</p>

If you forget the code and your phone is locked, your phone will require service. Additional charges may apply, and all the personal data in your phone may be deleted.

For more information, contact Nokia Care or your phone dealer.

Support

When you want to learn more about how to use your phone, or if you're unsure how your phone should work, read the user guide thoroughly.

If you have an issue, do the following:

- Reboot your phone. Switch off the phone, and remove the battery. After about a minute, replace the battery, and switch on the phone.
- Update your phone software
- Restore the original factory settings

If your issue remains unsolved, contact your network service provider or Nokia for repair options. Before sending your phone for repair, always back up your data, as all personal data in your phone may be deleted.

General information

Read these simple guidelines. Not following them may be dangerous or illegal. For further info, read the complete user guide.

 **SWITCH OFF IN RESTRICTED AREAS**
Switch the device off when mobile phone use is not allowed or when it may cause interference or danger, for example, in aircraft, in hospitals or near medical equipment, fuel, chemicals, or blasting areas. Obey all instructions in restricted areas.

 **ROAD SAFETY COMES FIRST**
Obey all local laws. Always keep your hands free to operate the vehicle while driving. Your first consideration while driving should be road safety.

 **INTERFERENCE**
All wireless devices may be susceptible to interference, which could affect performance.

 **QUALIFIED SERVICE**
Only qualified personnel may install or repair this product.

 **BATTERIES, CHARGERS, AND OTHER ACCESSORIES**
Use only batteries, chargers, and other accessories approved by Nokia for use with this device. Do not connect incompatible products.

 **KEEP YOUR DEVICE DRY**
Your device is not water-resistant. Keep it dry.

 **PROTECT YOUR HEARING**
To prevent possible hearing damage, do not listen at high volume levels for long periods. Exercise caution when holding your device near your ear while the loudspeaker is in use.

Product and safety information

Feature-specific instructions
The images in this guide may differ from your device screen.

To turn off notifications from apps to avoid data transfer costs, go to **Menu > Apps > My apps > Notifications > Options > Settings**.

 1 Avoid touching the antenna area while the antenna is in use. Contact with antennas affects the communication quality and may reduce battery life due to higher power level during operation.

 2 Use only compatible memory cards approved by Nokia for use with this device. Incompatible cards may damage the card and the device and corrupt data stored on the card.

 **Important:** Do not remove the memory card when an app is using it. Doing so may damage the memory card and the device and corrupt data stored on the card.

➡ **3 Important:** This device is designed to be used with a standard SIM card (see figure) only. Use of incompatible SIM cards may damage the card or the device, and may corrupt data stored on the card. Please consult your mobile operator for the use of a SIM card that has a mini-UICC cutout.



➡ **4** If the battery is completely discharged, it may take several minutes before the charging indicator is displayed or before any calls can be made.

➡ **5** Missed and received calls are logged only if supported by the network, and the phone is switched on and within the network service area.

If you only have one SIM card, put the card into the SIM1 card holder. Some features and services may only be available when using the SIM card in the SIM1 card holder. If there is a SIM card only in the SIM2 card holder, you can only make emergency calls.

➡ **6** Both SIM cards are available at the same time when the device is not being used, but while one SIM card is active, for example, making a call, the other is unavailable.

➡ **7** You can only use speed dials for the contacts stored on your phone or on the SIM in the internal SIM1 holder.

➡ **8** Using services or downloading content may cause transfer of large amounts of data, which may result in data traffic costs.

➡ **9** You can send text messages that are longer than the character limit for a single message. Longer messages are sent as two or more messages. Your service provider may charge accordingly.

Characters with accents, other marks, or some language options, take more space, limiting the number of characters that can be sent in a single message.

➡ **10** If the item you insert in a multimedia message is too large for the network, the device may automatically reduce the size.

➡ **11** Only compatible devices can receive and show multimedia messages. Messages may look different in different devices.

➡ **12** Sending a message with an attachment may be more expensive than sending a normal text message. For more information, contact your network service provider.

➡ **13** Operating the device in hidden mode is a safer way to avoid malicious software. Do not accept Bluetooth connection requests from sources you do not trust. You can also switch the Bluetooth function off when you are not using it.

➡ 14 Restoring settings does not affect documents or files stored on your phone.

➡ 15 To type in the + character, used for international calls, press * twice.

➡ 16 **⚠Warning:** When the flight profile is activated, you cannot make or receive any calls, including emergency calls, or use other features that require network coverage. To make a call, activate another profile.

When using this device, obey all laws and respect local customs, privacy and legitimate rights of others, including copyrights. Copyright protection may prevent you from copying, modifying, or transferring images, music, and other content.

Do not connect products that create an output signal, as this may damage the device. Do not connect any voltage source to the audio connector. If you connect an external device or headset, other than those approved by Nokia for use with this device, to the audio connector, pay special attention to volume levels.

Tips and Offers

To help you take maximum advantage of your phone and services, you receive free customised text messages from Nokia. The messages contain tips and tricks and support.

To stop receiving the messages, select **Menu > Settings > Nokia account > Tips and Offers**.

To provide the service described above, your mobile phone number, the serial number of your phone, and some identifiers of the mobile subscription are sent to Nokia when you use the phone for the first time. Some or all information may also be sent to Nokia when updating software. This information may be used as specified in the privacy policy, available at www.nokia.com.

Network services and costs

Your device is approved for use on the EGSM 900 and 1800 MHz networks. You need a subscription with a service provider.

Using some features and downloading content require network connection and may result in data costs. You may also need to subscribe to some features.

Take care of your device

Handle your device, battery, charger and accessories with care. The following suggestions help you keep your device in operation.

- Keep the device dry. Precipitation, humidity, and all types of liquids or moisture can contain minerals that corrode electronic circuits. If your device gets wet, remove the battery, and allow the device to dry.
- Do not use or store the device in dusty or dirty areas.

- Do not store the device in high temperatures. High temperatures may damage the device or battery.
- Do not store the device in cold temperatures. When the device warms to its normal temperature, moisture can form inside the device and damage it.
- Do not open the device other than as instructed in the user guide.
- Unauthorised modifications may damage the device and violate regulations governing radio devices.
- Do not drop, knock, or shake the device. Rough handling can break it.
- Only use a soft, clean, dry cloth to clean the surface of the device.
- Do not paint the device. Paint can prevent proper operation.
- Switch off the device and remove the battery from time to time for optimum performance.
- Keep your device away from magnets or magnetic fields.
- To keep your important data safe, store it in at least two separate places, such as your device, memory card, or computer, or write down important info.

Recycle

Always return your used electronic products, batteries, and packaging materials to dedicated collection points. This way you help prevent uncontrolled waste disposal and promote the recycling of materials. Check how to recycle your Nokia products at www.nokia.com/recycling.

For more info on recycling, see “Mobile Phone Recycling Explained in 2 Minutes” <http://www.youtube.com/watch?v=jD5yLicr6Js>

Crossed-out wheeled-bin symbol



The crossed-out wheeled-bin symbol on your product, battery, literature, or packaging reminds you that all electrical and electronic products and batteries must be taken to separate collection at the end of their working life. This requirement applies in the European Union and Turkey. Do not dispose of these products as unsorted municipal waste. For more environmental info, see the product Eco profile at www.nokia.com/ecoprofile.

About Digital Rights Management

When using this device, obey all laws and respect local customs, privacy and legitimate rights of others, including copyrights. Copyright protection may prevent you from copying, modifying, or transferring photos, music, and other content.

Digital rights management (DRM) protected content comes with an associated licence that defines your rights to use the content.

With this device you can access content protected with OMA DRM 2.0. If certain DRM software fails to protect the content, content owners may ask that such DRM

software's ability to access new DRM-protected content be revoked. Revocation may also prevent renewal of such DRM-protected content already in your device. Revocation of such DRM software does not affect the use of content protected with other types of DRM or the use of non-DRM-protected content.

Batteries and chargers

Battery and charger info

Use your device only with an original BL-4U rechargeable battery. Nokia may make additional battery models available for this device.

Charge your device with: AC-11 charger.

The battery can be charged and discharged hundreds of times, but it will eventually wear out. When the talk and standby times are noticeably shorter than normal, replace the battery.

Battery safety

Always switch the device off and unplug the charger before removing the battery. To unplug a charger or an accessory, hold and pull the plug, not the cord.

When your charger is not in use, unplug it. Do not leave a fully charged battery connected to a charger, as overcharging may shorten the battery's lifetime. If left unused, a fully charged battery will lose its charge over time.

Always keep the battery between 15°C and 25°C (59°F and 77°F). Extreme temperatures

reduce the capacity and lifetime of the battery. A device with a hot or cold battery may not work temporarily.

Accidental short-circuiting can happen when a metallic object touches the metal strips on the battery. This may damage the battery or the other object.

Do not dispose of batteries in a fire as they may explode. Obey local regulations. Recycle when possible. Do not dispose as household waste.

Do not dismantle, cut, crush, bend, puncture, or otherwise damage the battery in any way. If a battery leaks, do not let liquid touch skin or eyes. If this happens, immediately flush the affected areas with water, or seek medical help. Do not modify, attempt to insert foreign objects into the battery, or immerse or expose it to water or other liquids. Batteries may explode if damaged.

Use the battery and charger for their intended purposes only. Improper use, or use of unapproved or incompatible batteries or chargers may present a risk of fire, explosion, or other hazard, and may invalidate any approval or warranty. If you believe the battery or charger is damaged, take it to a service centre before continuing to use it. Never use a damaged battery or charger. Only use the charger indoors.

Additional safety information

Make an emergency call

1. Make sure the device is switched on.

2. Check for adequate signal strength. You may also need to do the following:

- Put a SIM card in the device.
 - Switch the call restrictions off in your device, such as call barring, fixed dialling, or closed user group.
 - Make sure the flight profile is not activated.
3. Press the end key repeatedly, until the home screen is shown.
4. Type in the official emergency number for your present location. Emergency call numbers vary by location.
5. Press the call key.
6. Give the necessary info as accurately as possible. Do not end the call until given permission to do so.

Important: Activate both cellular and internet calls, if your device supports internet calls. The device may attempt to make emergency calls both through cellular networks and through your internet call service provider. Connections in all conditions cannot be guaranteed. Never rely solely on any wireless device for essential communications like medical emergencies.

Small children

Your device and its accessories are not toys. They may contain small parts. Keep them out of the reach of small children.

Medical devices

Operation of radio transmitting equipment, including wireless phones, may interfere with inadequately shielded medical devices' function. Consult a physician or the medical

device's manufacturer to determine if it is adequately shielded from external radio energy.

Implanted medical devices

To avoid potential interference, manufacturers of implanted medical devices recommend a minimum separation of 15.3 centimetres (6 inches) between a wireless device and the medical device. Persons who have such devices should:

- Always keep the wireless device more than 15.3 centimetres (6 inches) from the medical device.
- Not carry the wireless device in a breast pocket.
- Hold the wireless device to the ear opposite the medical device.
- Switch the wireless device off if there is any reason to suspect that interference is taking place.
- Follow the manufacturer directions for the implanted medical device.

If you have any questions about using your wireless device with an implanted medical device, consult your health care provider.

Hearing

Warning: When you use the headset, your ability to hear outside sounds may be affected. Do not use the headset where it can endanger your safety.

Some wireless devices may interfere with some hearing aids.

Nickel

The surface of this device is nickel-free.

Protect your device from harmful content

Your device may be exposed to viruses and other harmful content. Take the following precautions:

- Be cautious when opening messages. They may contain malicious software or otherwise be harmful to your device or computer.
- Be cautious when accepting connectivity requests, browsing the internet, or downloading content. Do not accept Bluetooth connections from sources you do not trust.
- Only install and use services and software from sources that you trust and that offer adequate security and protection.
- Install antivirus and other security software on your device and any connected computer. Only use one antivirus app at a time. Using more may affect performance and operation of the device and/or computer.
- If you access preinstalled bookmarks and links to third party internet sites, take the appropriate precautions. Nokia does not endorse or assume liability for such sites.

Operating environment

This device meets radio frequency exposure guidelines in the normal use position at the ear or at least 1.5 centimetres (5/8 inch) away from the body. Any carry case, belt clip, or holder for body-worn operation should not contain metal and should position the

device the above-stated distance from your body.

The sending of data files or messages requires a quality network connection and may be delayed until such a connection is available. Follow the separation distance instructions until the sending is completed.

Vehicles

Radio signals may affect improperly installed or inadequately shielded electronic systems in vehicles. For more info, check with the manufacturer of your vehicle or its equipment.

Only qualified personnel should install the device in a vehicle. Faulty installation may be dangerous and invalidate your warranty. Check regularly that all wireless device equipment in your vehicle is mounted and operating properly. Do not store or carry flammable or explosive materials in the same compartment as the device, its parts, or accessories. Do not place your device or accessories in the air bag deployment area.

Potentially explosive environments

Switch your device off in potentially explosive environments, such as near petrol pumps. Sparks may cause an explosion or fire resulting in injury or death. Note restrictions in areas with fuel; chemical plants; or where blasting operations are in progress. Areas with a potentially explosive environment may not be clearly marked. These usually are areas where you are advised to switch your engine off, below deck on boats, chemical

transfer or storage facilities, and where the air contains chemicals or particles. Check with the manufacturers of vehicles using liquefied petroleum gas (such as propane or butane) if this device can be safely used in their vicinity.

Certification information (SAR)
This mobile device meets guidelines for exposure to radio waves.

Your mobile device is a radio transmitter and receiver. It is designed not to exceed the limits for exposure to radio waves recommended by international guidelines. These guidelines were developed by the independent scientific organisation ICNIRP and include safety margins designed to assure the protection of all persons, regardless of age and health.

The exposure guidelines for mobile devices employ a unit of measurement known as the Specific Absorption Rate or SAR. The SAR limit stated in the ICNIRP guidelines is 2.0 watts/kilogram (W/kg) averaged over 10 grams of tissue. Tests for SAR are conducted using standard operating positions with the device transmitting at its highest certified power level in all tested frequency bands. The actual SAR level of an operating device can be below the maximum value because the device is designed to use only the power required to reach the network. That amount changes depending on a number of factors such as how close you are to a network base station.

The highest SAR value under the ICNIRP guidelines for use of the device at the ear is 0.93 W/kg.

Use of device accessories may result in different SAR values. SAR values may vary depending on national reporting and testing requirements and the network band. Additional SAR information may be provided under product information at www.nokia.com.

DECLARATION OF CONFORMITY

CE 0168

Hereby, NOKIA CORPORATION declares that this RM-872 product is in compliance with the essential requirements and other relevant provisions of Directive 1999/5/EC. A copy of the Declaration of Conformity can be found at <http://www.nokia.com/global/declaration/declaration-of-conformity>.

© 2012 Nokia. All rights reserved.

Nokia, and Nokia Connecting People are trademarks or registered trademarks of Nokia Corporation. Nokia tune is a sound mark of Nokia Corporation. Other product and company names mentioned herein may be trademarks or tradenames of their respective owners.

Reproduction, transfer, distribution, or storage of part or all of the contents in this document in any form without the prior

written permission of Nokia is prohibited. Nokia operates a policy of continuous development. Nokia reserves the right to make changes and improvements to any of the products described in this document without prior notice.



Includes RSA BSAFE cryptographic or security protocol software from RSA Security.



Java
POWERED Oracle and Java are registered trademarks of Oracle and/or its affiliates.

The Bluetooth word mark and logos are owned by the Bluetooth SIG, Inc. and any use of such marks by Nokia is under license.

This product is licensed under the MPEG-4 Visual Patent Portfolio License (i) for personal and noncommercial use in connection with information which has been encoded in compliance with the MPEG-4 Visual Standard by a consumer engaged in a personal and noncommercial activity and (ii) for use in connection with MPEG-4 video provided by a licensed video provider. No license is granted or shall be implied for any other use. Additional information, including that related to promotional, internal, and

commercial uses, may be obtained from MPEG LA, LLC. See <http://www.mpegla.com>.

To the maximum extent permitted by applicable law, under no circumstances shall Nokia or any of its licensors be responsible for any loss of data or income or any special, incidental, consequential or indirect damages howsoever caused.

The contents of this document are provided "as is". Except as required by applicable law, no warranties of any kind, either express or implied, including, but not limited to, the implied warranties of merchantability and fitness for a particular purpose, are made in relation to the accuracy, reliability or contents of this document. Nokia reserves the right to revise this document or withdraw it at any time without prior notice.

The availability of products, features, apps, and services may vary by region. For more info, contact your Nokia dealer or your service provider. This device may contain commodities, technology or software subject to export laws and regulations from the US and other countries. Diversion contrary to law is prohibited.

Nokia does not provide a warranty for or take any responsibility for the functionality, content, or end-user support of third-party apps provided with your device. By using an app, you acknowledge that the app is provided as is. Nokia does not make any representations, provide a warranty, or take any responsibility for the functionality,

content, or end-user support of third-party apps provided with your device.

The availability of Nokia services may vary by region.

Some operations and features are SIM card and/or network dependent, MMS dependent, or dependent on the compatibility of devices and the content formats supported. Some services are subject to a separate charge.